



<b>Licence number</b>	L9249/2020/1
<b>Licence holder</b>	Claw Environmental Pty Ltd
<b>ACN</b>	621 244 139
<b>Registered business address</b>	22 Stirling Road, GREENMOUNT WA 6056
<b>DWER file number</b>	DER2020/000124
<b>Duration</b>	31/08/2020 to 30/08/2040
<b>Date of issue</b>	31 August 2020
<b>Premises details</b>	Claw Environmental 5 Forge Street WELSHPOOL WA 6106  Legal description – Part Lot 202 on Deposited Plan 9507 And Part Lot 86 on Deposited Plan 7655 As defined by the coordinates in Schedule 1

<b>Prescribed premises category description (Schedule 1, <i>Environmental Protection Regulations 1987</i>)</b>	<b>Assessed production / design capacity</b>
Category 61A: Solid waste facility: premises (other than premises within category 67A) on which solid waste produced on other premises is stored, reprocessed, treated, or discharged onto land.	4,500 tonnes per annual period

This Licence is granted to the licence holder, subject to the following conditions, on 31 August 2020, by:

**Tracey Hassell**  
**A/MANAGER WASTE INDUSTRIES**

an officer delegated under section 20 of the *Environmental Protection Act 1986 (WA)*

## Interpretation

In this licence:

- (a) the words 'including', 'includes' and 'include' in conditions mean "including but not limited to", and similar, as appropriate;
- (b) where any word or phrase is given a defined meaning, any other part of speech or other grammatical form of that word or phrase has a corresponding meaning;
- (c) where tables are used in a condition, each row in a table constitutes a separate condition;
- (d) any reference to an Australian or other standard, guideline, or code of practice means the version of the standard, guideline, or code of practice in force at the time of granting of this licence and includes any amendments to the standard, guideline or code of practice which may occur from time to time during the course of the licence;
- (e) unless specified otherwise, any reference to a section of an Act refers to that section of the EP Act; and
- (f) unless specified otherwise, all definitions are in accordance with the EP Act.

**NOTE:** This licence requires specific conditions to be met but does not provide any implied authorisation for other emissions, discharges, or activities not specified in this licence.

## Licence conditions

The licence holder must ensure that the following conditions are complied with:

### Waste Acceptance

1. The licence holder must only accept onto the Premises waste of a waste type, which does not exceed the corresponding rate at which waste is received, and which meets the corresponding acceptance specification set out in Table 1.

**Table 1: Waste acceptance**

Waste type	Rate at which waste is received	Acceptance specification
Inert Waste Type 2	4,500 tonnes per annual period	Limited to rigid plastics and polystyrene

2. The licence holder shall ensure that where waste does not meet the waste acceptance criteria set out in Condition 1, it is removed from the Premises by the delivery vehicle or, where that is not possible, stored in a quarantined storage area or container and removed to an appropriately authorised facility as soon as practicable.
3. The licence holder shall ensure that wastes accepted onto the Premises are only subjected to the processes set out in Column 2 of Table 2, and in accordance with any process requirements/limits described in Column 3 of Table 2.

**Table 2: Waste Processing**

Column 1	Column 2	Column 3
Waste type (as specified in Condition 1)	Process	Process requirements/limits
Inert Waste Type 2	Receipt, handling, processing and storage prior to removal off-site.	<ul style="list-style-type: none"> <li>All waste accepted onto site shall be directed to the receipt area for processing or storage as required; and</li> <li>All non-conforming waste types are to be removed for disposal off-site.</li> </ul>
	Shredding	<ul style="list-style-type: none"> <li>All plastics requiring shredding shall be inspected for non-conforming waste.</li> <li>No non-conforming waste is to be shredded;</li> <li>Plastics are to be fed into the shredder via the main feed conveyor with shredded material transferred directly into bulka bags;</li> <li>Bulka bags must be stored in the storage area or transferred directly to the next step of processing.</li> </ul>
	Wash and Granulate	<ul style="list-style-type: none"> <li>All wash water from the washing process must be captured and contained within a closed system that prevents offsite discharge;</li> <li>Once cleaned and washed, the material must be dried prior to being transferred to Granule Silo 1 as depicted in Figure 2.</li> <li>Material from Granule Silo 1 must be transferred into bulka bags, and stored in the rear storage area or transferred directly to be pelletised.</li> <li>All non-conforming waste types collected as part of the washing and granulating process are to be removed for disposal off-site.</li> </ul>
	Pelletising	<ul style="list-style-type: none"> <li>Plastic shall be fed into the extruder via a feed hopper;</li> <li>Molten plastic must be forced through a screen to remove fine contaminants. These screens to be cleaned replaced regularly.</li> <li>Material from the pelletiser must be transferred into bulka bags and placed in storage containers situated along the driveway or the rear storage area as depicted in Figure 2.</li> </ul>

- The licence holder shall take all reasonable and practical measures to prevent windblown waste from escaping from the Premises and that any windblown waste that does escape is collected, on at least a weekly basis, and is appropriately contained.

## Infrastructure and equipment

- The licence holder must ensure that the site infrastructure and equipment listed in Table 3 and located at the corresponding infrastructure location listed in Table 3 is maintained and operated in accordance with the corresponding operational requirement set out in Table 3.

**Table 3: Infrastructure and equipment requirements**

Infrastructure and equipment	Operational requirement	Infrastructure location (Figure 2)
Shredder (Zerma ZIS1500)	Must be operated on a concrete/bitumen hardstand base/floor and within an enclosed building.	Shred_ZIS
Shredder (Zerma ZSS1500)	Must be operated on a concrete/bitumen hardstand base/floor and within an enclosed building.	Shred_ZSS
Shredder (Genox GXS4080)	Must be operated on a concrete/bitumen hardstand base/floor within a noise insulated enclosed area.	Shred_Gen
Granulator (Handel SC14/26)	Must be operated on a concrete/bitumen hardstand base/floor and within an enclosed building.	Gran_H1
Wash Line (Tongli)	Must be operated on a concrete/bitumen hardstand base/floor and within an enclosed building.	WL1
Extruder_PP (Shek Shing Machinery)	Must be operated on a concrete/bitumen hardstand base/floor and within an enclosed building.	Ext_PP
Extruder (Erema RG120)	Must be operated on a concrete/bitumen hardstand base/floor and within an enclosed building.	Ext_Erema
EPS Granulator (Treffnor V10)	Must be operated on a concrete/bitumen hardstand base/floor and within an enclosed building. All wash water must be captured and contained within an enclosed system.	EPS_Gran
EPS Granulator (Runi SK370)	Must be operated on a concrete/bitumen hardstand base/floor and within an enclosed building.	EPS_Runi
Forklift (TCM FD25T3)	Must be maintained and kept in good operational condition at all times. Forklift to be fitted with spark arrestors to exhaust systems.	N/A
Forklift (TCM FD25T3KT)	Must be maintained and kept in good operational condition at all times. Forklift to be fitted with spark arrestors to exhaust systems.	N/A
Bobcat (Bobcat S150)	Must be maintained and kept in good operational condition at all times.	N/A
Stormwater screens	<ul style="list-style-type: none"> <li>• Weekly inspection and clean to be conducted to assess the integrity and operational status of the stormwater screens; and</li> <li>• A written log is to be maintained for each inspection, with the record of each inspection signed by the person conducting the inspection.</li> </ul>	Storm drains as depicted in Figures 3 and 4.

Infrastructure and equipment	Operational requirement	Infrastructure location (Figure 2)
Fire prevention system	Must be operational at all times.	N/A
Perimeter fencing	Inspected weekly and maintained on an as required basis.	N/A

## Monitoring

6. The licence holder must monitor and record the total amount of waste accepted onto, or removed from the premises, as specified in Column 1 of Table 4, for the corresponding waste types specified in Column 2 of Table 4, for the corresponding units specified in Column 3 of Table 4, and at the corresponding frequency, as specified in Column 4, of Table 4.

**Table 4: Monitoring of inputs and outputs**

Column 1	Column 2	Column 3	Column 4
Inputs / Outputs	Waste types	Units	Frequency
Waste accepted onto the premises	Inert Waste Type 2	Tonnes	Each load arriving at the Premises
Waste removed from the premises	Inert Waste Type 2	Tonnes	Each load leaving or rejected from the Premises.
	Non-conforming wastes	Tonnes	Each load leaving the Premises.
	Wastewater from the wash line.	Tonnes	Each load removed from the Premise.

## Records and reporting

7. The licence holder must maintain accurate and auditable books including the following records, information, reports and data required by this Licence:
- the calculation of fees payable in respect of this Licence;
  - the maintenance of infrastructure required to ensure that it is kept in good working order in accordance with Condition 5 of this Licence;
  - monitoring undertaken in accordance with Condition 6 of this Licence; and
  - complaints received under Condition 8 of this Licence

In addition, the Books must:

- be legible;
  - if amended, be amended in such a way that the original version(s) and any subsequent amendments remain legible and are capable of retrieval;
  - be retained by the licence holder for the duration of the licence; and
  - be available to be produced to an inspector or the CEO as required.
8. The licence holder must record the following information in relation to complaints received by the licence holder (whether received directly from a complainant or forwarded to them by the Department or another party) about any alleged emissions from the premises:

- (a) the name and contact details of the complainant, (if provided);
  - (b) the time and date of the complaint;
  - (c) the complete details of the complaint and any other concerns or other issues raised; and
  - (d) the complete details and dates of any action taken by the licence holder to investigate or respond to any complaint.
9. The licence holder must:
- (a) undertake an audit of their compliance with the conditions of this licence during the preceding annual period; and
  - (b) prepare and submit to the CEO by no later than 30 days after the end of that annual period an Annual Audit Compliance Report in the approved form.

## Noise Validation

10. Within 120 days of the commencement date of this licence, the licence holder must retain the services of a person qualified and experienced in the area of environmental noise assessment and who, by their qualifications and experience, is eligible to hold membership of the Australian Acoustical Society or the Australian Association of Acoustical Consultants to:
- (a) investigate the nature and extent of noise emissions from the premises;
  - (b) assess in accordance with the methodology required in the *Environmental Protection (Noise) Regulations 1997*, the compliance of the noise emissions from the prescribed premise, against the relevant assigned levels specified in those Regulations; and
  - (c) compile and submit to the licence holder within six (6) months of the commencement date of this licence a report in accordance with Condition 11.
11. A report prepared pursuant to Condition 11(c) is to include:
- (a) a description of the methods used for monitoring and/or modelling of noise emissions from the premises;
  - (b) details and the results of the investigation undertaken pursuant to Condition 10(a);
  - (c) details and results of the assessment of the noise emissions from the premises, against the relevant assigned levels in the *Environmental Protection (Noise) Regulations 1997* undertaken pursuant to Condition 10(b); and
  - (d) an assessment of noise levels against the most recent previous noise assessment.
12. The licence holder must submit to the CEO the report prepared pursuant to Condition 10(c) within 14 days of receiving it.
13. Where an assessment pursuant to Condition 10(b) indicates that noise emissions do not comply with the relevant assigned levels in the *Environmental Protection (Noise) Regulations 1997*, the license holder must:
- (a) within 60 days of receiving an assessment report pursuant to Condition 10(c) prepare a plan to ensure the undertaking of the licensed activity will no longer lead to any contravention of the *Environmental Protection (Noise) Regulations 1997*; and

- (b) provide to the CEO, a copy of the plan prepared pursuant to Condition 10(a) within 30 days of its preparation.

## Fire Management

**14.** The license holder must:

- (a) maintaining an emergency response plan with respect to fire, in accordance with AS 3745, and include drainage plans, maps and relevant MSDS information;
- (b) ensure all drainage plans, maps and relevant MSDS are available to fire responders at the entrance to facility;
- (c) operate an on-site fire detection system, e.g. thermal detection cameras;
- (d) minimise the size of stockpiles of recyclable materials that could cause a fire hazard;
- (e) ensure there are a sufficient number of fire hoses on the Premises such that all areas of processing can be reached;
- (f) ensure that any fire on the Premises is extinguished as soon as possible;
- (g) ensure clear access to all stormwater drains is maintained at all times.
- (h) ensure that pollution control equipment such as fire water booms, drain mats, or sandbags (or any other compatible absorbent material) be available on site, sufficient to divert run-off from, or prevent drainage into, at least two stormwater drains on the storage area and two stormwater drains on the processing area at any one time (four drains in total);
- (i) ensure that pollution control equipment listed in condition 14(h) be deployed, when possible and safe to do so, in the event of a fire; and
- (j) ensure that any water generated from fire-fighting activities is removed from the Premises by a carrier licensed under the *Environmental Protection (Controlled Waste) Regulations 2004*.

## Definitions

In this licence, the terms in Table 5 have the meanings defined.

**Table 5: Definitions**

Term	Definition
ACN	Australian Company Number
Annual Audit Compliance Report (AACR)	means a report submitted in a format approved by the CEO (relevant guidelines and templates may be available on the Department's website).
annual period	a 12 month period commencing from 1 July until 30 June of the immediately following year.
books	has the same meaning given to that term under the EP Act.
CEO	means Chief Executive Officer of the Department. "submit to / notify the CEO" (or similar), means either: Director General Department administering the <i>Environmental Protection Act 1986</i> Locked Bag 10 Joondalup DC WA 6919 or: <a href="mailto:info@dwer.wa.gov.au">info@dwer.wa.gov.au</a>
Department	means the department established under section 35 of the <i>Public Sector Management Act 1994 (WA)</i> and designated as responsible for the administration of the EP Act, which includes Part V Division 3.
discharge	has the same meaning given to that term under the EP Act.
emission	has the same meaning given to that term under the EP Act.
EP Act	<i>Environmental Protection Act 1986 (WA)</i>
EP Regulations	<i>Environmental Protection Regulations 1987 (WA)</i>
Inert Waste Type 2	Inert waste type II category waste as defined in the <i>Landfill Waste Classification and Waste Definitions 1996 (as amended 2019)</i> .
licence	refers to this document, which evidences the grant of a licence by the CEO under section 57 of the EP Act, subject to the specified conditions contained within.
licence holder	refers to the occupier of the premises, being the person specified on the front of the licence as the person to whom this licence has been granted.



<b>Term</b>	<b>Definition</b>
Premises	refers to the premises to which this licence applies, as specified at the front of this licence and as shown on the premises map in Schedule 1 to this licence.
prescribed premises	has the same meaning given to that term under the EP Act.
Waste	has the same meaning given to that term under the EP Act.

---

**END OF CONDITIONS**

## Schedule 1: Maps

### Premises map

Figure 1: Prescribed Premise Boundary and Co-ordinates



Figure 2: Site Infrastructure and Site Layout

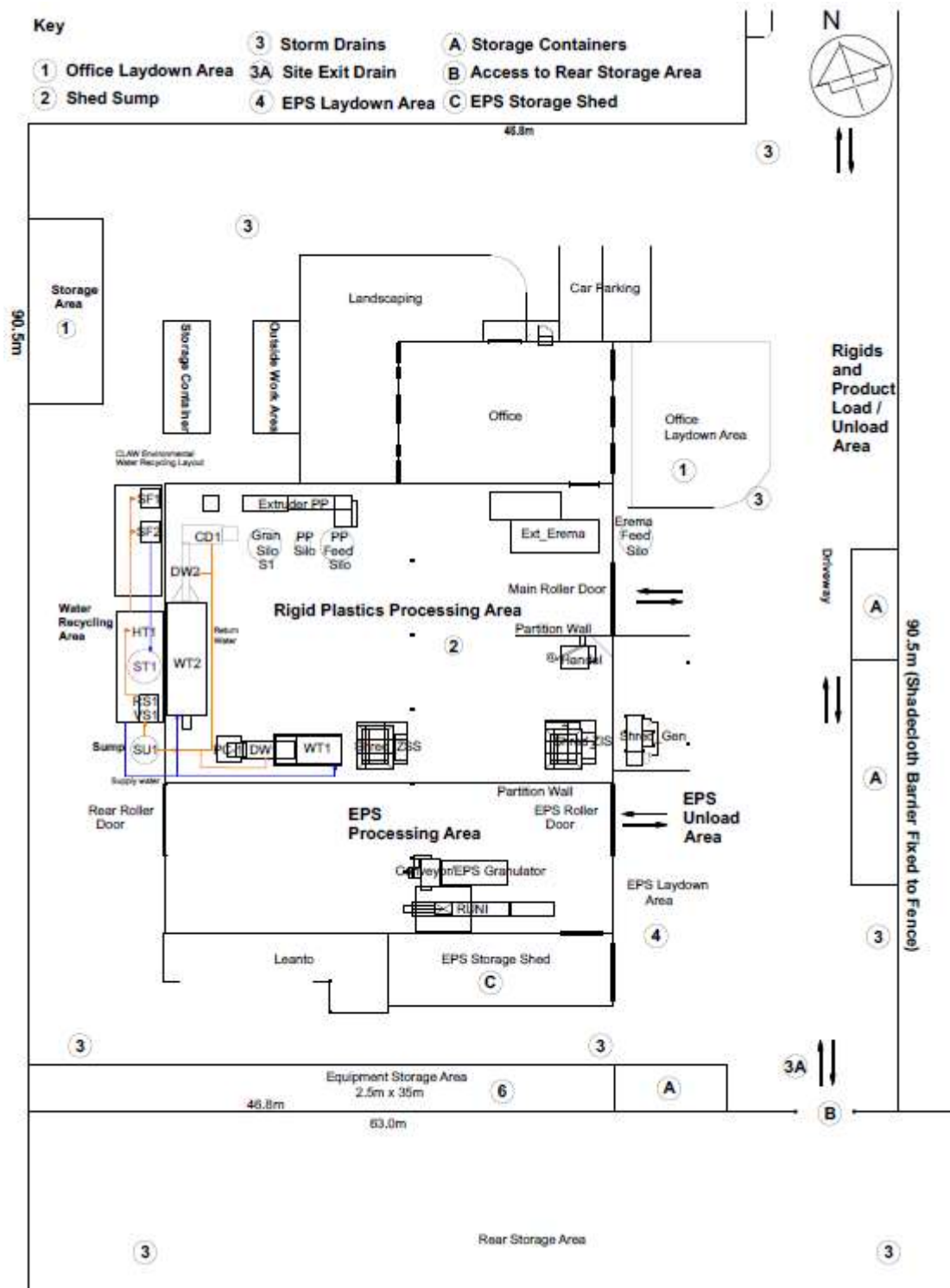
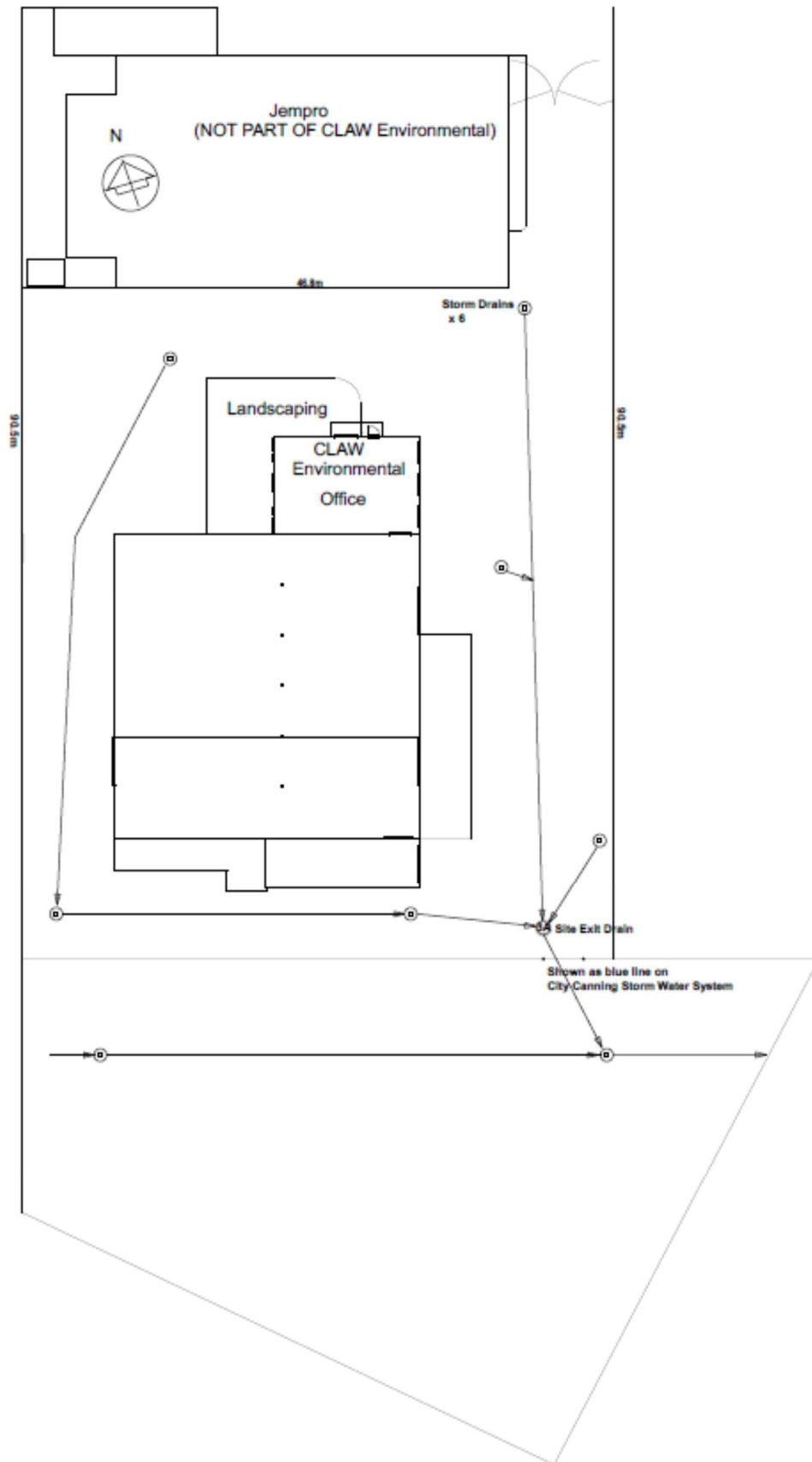

Figure 3: Site Drainage Infrastructure and Equipment



**Figure 4: Site Drainage Screen Assembly**

