



**Works approval number** W6582/2021/1

**Works approval holder** Resource Accommodation Management Pty Ltd  
**ACN** 158 999 958  
**Registered business address** Suite 5, Level 2, 2 Grosvenor Street  
Bondi Junction NSW 2022  
**DWER file number** DER2021/000389

**Duration** 10/05/2022 to 09/05/2027

**Date of issue** 10/05/2022

**Premises details** Norseman Accommodation Village Wastewater  
Treatment Plant  
51 Richardson Street  
NORSEMAN WA 6443  
Legal description -  
Lot 874 on Plan 172130

Prescribed premises category description (Schedule 1, <i>Environmental Protection Regulations 1987</i> )	Assessed design capacity
Category 85: Sewage facility: Premises – (a) On which sewage is treated (excluding septic tanks); or (b) From which treated sewage is discharged onto land into waters	51.5 m <sup>3</sup> per day

This works approval is granted to the works approval holder, subject to the attached conditions, on 10 May 2022, by:

**Steve Checker**  
**MANAGER WASTE INDUSTRIES**  
**REGULATORY SERVICES**

an officer delegated under section 20 of the *Environmental Protection Act 1986* (WA)

## Works approval history

Date	Reference number	Summary of changes
10/05/2022	W6582/2021/1	Works approval granted.

## Interpretation

In this works approval:

- (a) the words 'including', 'includes' and 'include' in conditions mean "including but not limited to", and similar, as appropriate;
- (b) where any word or phrase is given a defined meaning, any other part of speech or other grammatical form of that word or phrase has a corresponding meaning;
- (c) where tables are used in a condition, each row in a table constitutes a separate condition;
- (d) any reference to an Australian or other standard, guideline, or code of practice in this works approval:
  - (i) if dated, refers to that particular version; and
  - (ii) if not dated, refers to the latest version and therefore may be subject to change over time;
- (e) unless specified otherwise, any reference to a section of an Act refers to that section of the EP Act; and
- (f) unless specified otherwise, all definitions are in accordance with the EP Act.

**NOTE:** This works approval requires specific conditions to be met but does not provide any implied authorisation for other emissions, discharges, or activities not specified in this works approval.

# Works approval conditions

The works approval holder must ensure that the following conditions are complied with:

## Construction phase

### Infrastructure and equipment

1. The works approval holder must:
  - (a) construct and/or install the infrastructure;
  - (b) in accordance with the corresponding design and construction / installation requirements; and
  - (c) at the corresponding infrastructure location; and
 as set out in Table 1.

**Table 1: Design and construction / installation requirements**

	Infrastructure	Design and construction / installation requirements	Infrastructure location (Figure 1, Schedule 1)
1.	Wastewater treatment plant (WWTP) and associated infrastructure	(a) Influent settling (anaerobic) tanks for primary treatment, with an effluent filter outlet & sludge removal outlets; (b) Re-circulation pre-treatment tanks for secondary treatment and emergency storage; (c) Aerobic tanks, aerocell foam biotreatment modules & feed pumps; (d) Splitter and Transfer Pump Station for recirculation, or return to pre-treatment septic tank; (e) Chlorination sanitisation system, for dosage into final discharge irrigation tank; (f) Final Discharge Irrigation Tank/Pump; (g) Sanitisation System; (h) A series of high-density polyethylene (HDPE) piping, pumps, filters, control system and power supply; and (i) Must be able to treat wastewater to low Exposure Risk Level (ERL) for irrigation as per DoH guidelines. (j) Water must be available onsite for dust suppression and used if visual inspections indicate a need. (k) Visual dust inspections must be carried out regularly and measures taken to ensure no visible dust leaves the premises boundary. (l) Constructed to be able to achieve the	Proposed sewage treatment plant

	Infrastructure	Design and construction / installation requirements	Infrastructure location (Figure 1, Schedule 1)
		following treated waste water outputs: <ul style="list-style-type: none"> <li>• Total output: 51.5 m<sup>3</sup>/day</li> <li>• TSS: 30 mg/L</li> <li>• BOD5: &lt;20 mg/L</li> <li>• pH: 6.5 – 8.5</li> <li>• Chloring: 0.2 - 2.0 mg/L</li> <li>• <i>E.coli</i>: &lt;1,000 CFU/100mL</li> <li>• TN: &lt;14 mg/L</li> <li>• TP: &lt;11.25 mg/L</li> </ul>	
2.	Irrigation field	(a) 2,500 m <sup>2</sup> flatbed irrigation system over a 4,000 m <sup>2</sup> area; (b) Fully fenced perimeter with appropriate signage to restrict public access.	Flatbed

## Compliance reporting

2. The works approval holder must within 60 calendar days of an item of infrastructure or equipment required by condition 1 being constructed and/or installed:
  - (a) undertake an audit of their compliance with the requirements of condition 1; and
  - (b) prepare and submit to the CEO an Environmental Compliance Report on that compliance.
3. The Environmental Compliance Report required by condition 2, must include as a minimum the following:
  - (a) certification by a suitably qualified and experienced engineer that the items of infrastructure or component(s) thereof, as specified in condition 1, have been constructed in accordance with the relevant requirements specified in condition 1;
  - (b) as constructed plans and a detailed site plan for each item of infrastructure or component of infrastructure specified in condition 1; and
  - (c) be signed by a person authorised to represent the works approval holder and contains the printed name and position of that person.

## Environmental commissioning phase

### Environmental commissioning requirements and emission limits

4. The works approval holder may only commence environmental commissioning of an item of infrastructure identified in condition 1 once the Environmental Compliance Report has been submitted for that item of infrastructure in accordance with condition 2 of this works approval.

5. Any environmental commissioning activities undertaken for an item of infrastructure listed in condition 1 may only be carried out:
  - (a) In accordance with the corresponding commissioning requirements; and
  - (b) For the corresponding authorised commissioning duration, as detailed in Table 2.

**Table 2: Environmental commissioning requirements**

	Infrastructure	Commissioning requirements	Authorised commissioning duration
1.	Wastewater treatment plant and associated infrastructure	Only irrigate treated wastewater from the WWTP to the designated irrigation field, as specified by Schedule 1, Figure 1.	For a period not exceeding 30 days
2.	Irrigation field	Ensure no leaks or pipe ruptures occur. No discharge of untreated wastewater authorised.	

### Monitoring during environmental commissioning

6. The works approval holder must monitor emission during environmental commissioning in accordance with Table 3.
7. The works approval holder must record the results of all monitoring activity required by condition 6 and submit the results as an Environmental Commissioning Report to the CEO by no later than 30 days after the end of the commissioning period during which irrigation to land has occurred.

**Table 3: Emissions monitoring during environmental commissioning**

Discharge point	Monitoring location	Parameter	Frequency	Averaging period	Unit	Method
Irrigation field – as depicted in Schedule 1, Figure 1	Pipeline leading to irrigation field	Flow volume to irrigation field	Continuous	24 hours	kL/day	-
		Biochemical Oxygen Demand (BOD)	Fortnightly	Spot sample	mg/L	AS/NZS 5667.10 - 1998
		Total Suspended Solids (TSS)				Measurement of pH with a serviced and calibrated field water quality meter is permitted.
		Total Nitrogen (TN)				Measurement of residual free chlorine with field-based equipment is permitted.
		Total phosphorus (TP)				
		<i>E. coli</i>				For all other

		Total dissolved solids (TDS)			mg/L	parameter's samples must be submitted to and tested by a laboratory with NATA accreditation.
		Residual Free Chlorine	Daily			
		pH			N/A	

## Time limited operations phase

### Commencement and duration

- 8.** The works approval holder may only commence time limited operations for an item of infrastructure identified in condition 1:
- Where an item of infrastructure is not authorised to undertake environmental commissioning, the Environmental Compliance Report as required by condition 2 has been submitted by the works approval holder for that item of infrastructure; and
  - Where an item of infrastructure is authorised to undertake environmental commissioning under condition 4, the Environmental Commissioning Report for that item of infrastructure as required by condition 7 has been submitted by the works approval holder
- 9.** The works approval holder may conduct time limited operations for an item of infrastructure specified in condition 1:
- For a period not exceeding 180 calendar days from the day the works approval holder meets the requirements of condition 8 for that item of infrastructure.

### Monitoring during time limited operations

- 10.** The works approval holder must monitor treated wastewater emissions during time limited operations in accordance with Table 4.
- 11.** The works approval holder must record the results of all monitoring activity required by condition 10. Within 30 days of the end of the time limited operations period, the works approval holder shall submit a report to the CEO detailing the monitoring records.

**Table 4: WWTP emissions monitoring during time limited operations**

Discharge point	Monitoring location	Parameter	Frequency	Averaging period	Unit	Method
Irrigation field – as depicted in Schedule 1, Figure 1	Pipeline leading to irrigation field	Flow volume to irrigation field	Continuous	24 hours	kL/day	-
		BOD	Monthly	Spot sample	mg/L	AS/NZS 5667.10 - 1998 Measurement of pH with a
		TSS				
		TN				

		TP				serviced and calibrated field water quality meter is permitted.
		<i>E. coli</i>			cfu/100ml	
		TDS				Measurement of residual free chlorine with field-based equipment is permitted.
		Residual Free Chlorine			mg/L	
		pH	Daily		N/A	For all other parameter's samples must be submitted to and tested by a laboratory with NATA accreditation.

## Records and reporting (general)

- 12.** The works approval holder must record the following information in relation to complaints received by the works approval holder (whether received directly from a complainant or forwarded to them by the Department or another party) about any alleged emissions from the premises:
- the name and contact details of the complainant, (if provided);
  - the time and date of the complaint;
  - the complete details of the complaint and any other concerns or other issues raised; and
  - the complete details and dates of any action taken by the works approval holder to investigate or respond to any complaint.
- 13.** The works approval holder must maintain accurate and auditable books including the following records, information, reports, and data required by this works approval:
- the works conducted in accordance with condition 1;
  - any maintenance of infrastructure that is performed in the course of complying with condition 1;
  - monitoring programmes undertaken in accordance with conditions 6, 7, 10, and 11; and
  - complaints received under condition 12.
- 14.** The books specified under condition 13 must:
- be legible;
  - if amended, be amended in such a way that the original version(s) and any subsequent amendments remain legible and are capable of retrieval;

- (c) be retained by the works approval holder for the duration of the works approval;  
and
- (d) be available to be produced to an inspector or the CEO as required.



## Definitions

In this works approval, the terms in Table 1 have the meanings defined.

**Table 1: Definitions**

Term	Definition
books	has the same meaning given to that term under the EP Act.
CEO	means Chief Executive Officer. CEO for the purposes of notification means:  Director General Department administering the <i>Environmental Protection Act 1986</i> Locked Bag 10 Joondalup DC WA 6919  <a href="mailto:info@dwer.wa.gov.au">info@dwer.wa.gov.au</a>
Department	means the department established under section 35 of the <i>Public Sector Management Act 1994</i> and designated as responsible for the administration of Part V Division 3 of the EP Act.
discharge	has the same meaning given to that term under the EP Act.
emission	has the same meaning given to that term under the EP Act.
environmental commissioning	means the sequence of activities to be undertaken to test equipment integrity and operation, or to determine the environmental performance, of equipment and infrastructure to establish or test a steady state operation and confirm design specifications.
Environmental Commissioning Report	means a report on any commissioning activities that have taken place and a demonstration that they have concluded, with focus on emissions and discharges, waste containment, and other environmental factors.
Environmental Compliance Report	means a report to satisfy the CEO that the conditioned infrastructure and/or equipment has been constructed and/or installed in accordance with the works approval.
EP Act	<i>Environmental Protection Act 1986 (WA)</i> .
EP Regulations	<i>Environmental Protection Regulations 1987 (WA)</i> .
premises	the premises to which this licence applies, as specified at the front of this licence and as shown on the premises map in Schedule 1 to this works approval.
prescribed premises	has the same meaning given to that term under the EP Act.
time limited	refers to the operation of the infrastructure and equipment identified under this works approval that is authorised for that

<b>Term</b>	<b>Definition</b>
operations	purpose, subject to the relevant conditions.
waste	has the same meaning given to that term under the EP Act.
works approval	refers to this document, which evidences the grant of the works approval by the CEO under section 54 of the EP Act, subject to the conditions.
works approval holder	refers to the occupier of the premises being the person to whom this works approval has been granted, as specified at the front of this works approval.

---

**END OF CONDITIONS**

# Schedule 1: Maps

## Premises map

The boundary of the prescribed premises is shown in the map below (Figure 1).

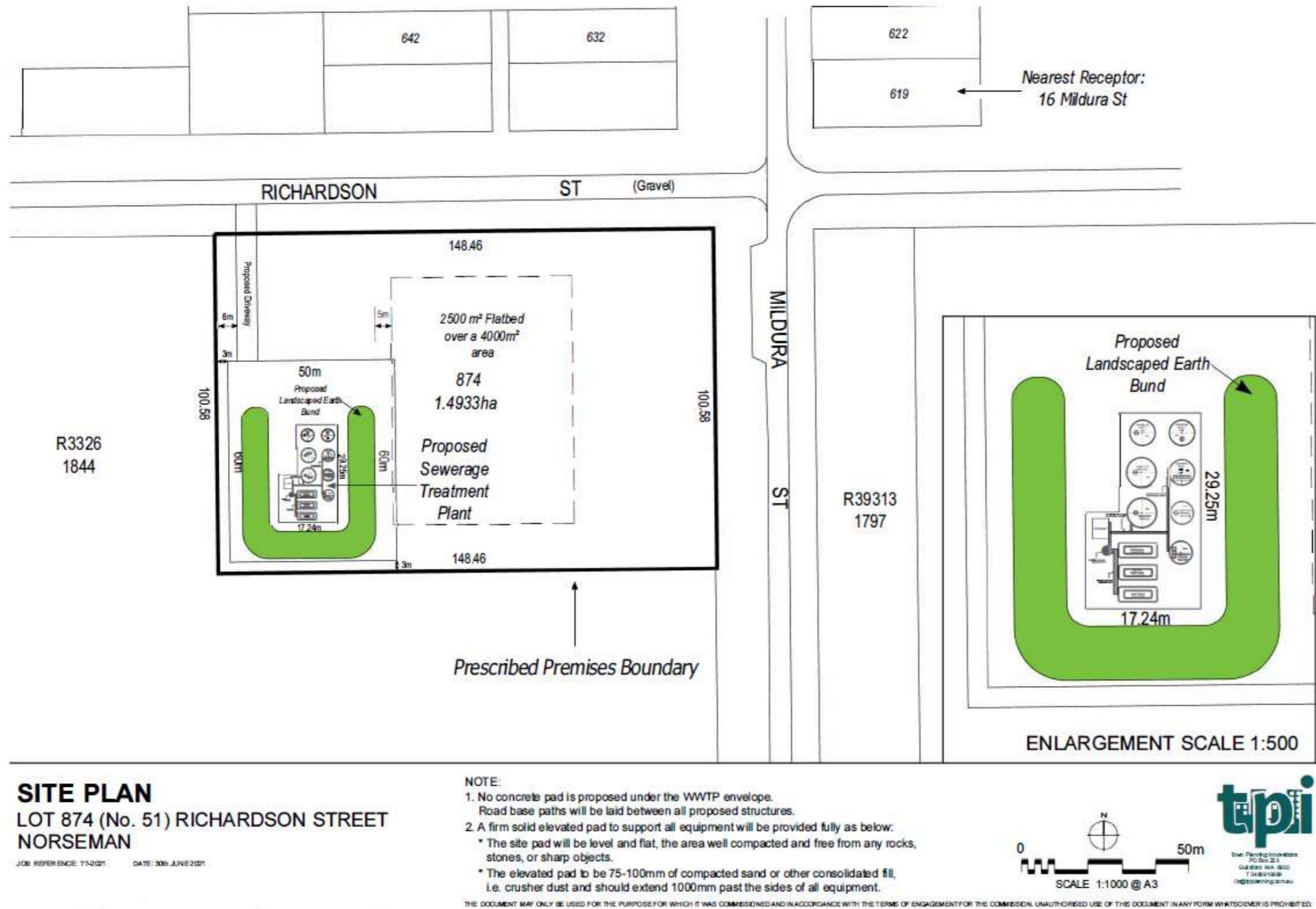

Figure 1: Map of the boundary of the prescribed premise