



Licence number	L8791/2013/2
Licence holder	Department of Infrastructure, Transport, Regional Development, Communications, Sports and the Arts
Registered business address	111 Alinga Street CANBERRA CITY ACT 2601
DWER file number	INS-0001871 and APP-0033856
Duration	06/03/2014 to 07/03/2031
Date of issue	06/03/2014
Date of amendment	06/03/2026
Premises details	Christmas Island Power Station Being on Lot 500 of Plan 63606 as depicted in Schedule 1 CHRISTMAS ISLAND WA 6798

Prescribed premises category description (Schedule 1, <i>Environmental Protection Regulations 1987</i>)	Assessed production / design capacity
Category 52: Electric power generation	24 Mwe per annual period
Category 73: Bulk storage of chemicals, etc: premises on which acids, alkalis or chemicals that – (a) Contain at least one carbon to carbon bond; and (b) Are liquid as STP standard temperature and pressure, Are stored.	1,073 cubic metres (diesel) per annual period

This licence is granted to the licence holder, subject to the attached conditions, on 06 March 2026, by:

Grace Heydon

MANAGER WASTE INDUSTRIES

an officer delegated under section 20 of the *Environmental Protection Act 1986* (WA)

[L8791/2013/3 \(06 March 2026\)](#)

Licence history

Date	Reference number	Summary of changes
25/03/2006	L8092/1	New application
26/03/2007	L8092/2	Licence re-issue
26/03/2008	L8092/3	Licence re-issue
05/01/2009	L8092/4	Licence re-issue
09/08/2010	L8092/5	Licence re-issue
28/10/2011	L8092/6	Licence amendment
08/03/2013	L8092/7	Licence amendment
06/02/2014	L8791/2013/1	New licence in REFIRE format
16/04/2014	W5620/2014/1	Works approval for upgrade of storage tanks and tank farm
27/11/2014	L8791/2013/1	Licence amendment for addition of Category 73
29/04/2016	L8791/2013/1	Amendment Notice 1 – Amendment to extend licence duration to 7 March 2026
16/02/2018	L8791/2013/1	Amendment Notice 2 – Amendment to address hydrocarbon management
06/03/2026	L8791/2013/2	Licence renewal – extend expiry date This renewal includes an amalgamation of amendment Notice 1 and 2 into the current licence format.

Interpretation

In this licence:

- (a) the words ‘including’, ‘includes’ and ‘include’ in conditions mean “including but not limited to”, and similar, as appropriate;
- (b) where any word or phrase is given a defined meaning, any other part of speech or other grammatical form of that word or phrase has a corresponding meaning;
- (c) where tables are used in a condition, each row in a table constitutes a separate condition;
- (d) any reference to an Australian or other standard, guideline, or code of practice in this licence:
 - (i) if dated, refers to that particular version; and

Department of Water and Environmental Regulation

- (ii) if not dated, refers to the latest version and therefore may be subject to change over time;
- (e) unless specified otherwise, any reference to a section of an Act refers to that section of the EP Act; and
- (f) unless specified otherwise, all definitions are in accordance with the EP Act.

NOTE: This licence requires specific conditions to be met but does not provide any implied authorisation for other emissions, discharges, or activities not specified in this licence.

Licence conditions

The licence holder must ensure that the following conditions are complied with:

Infrastructure and equipment

- The licence holder must ensure that the site infrastructure and equipment listed in Table 1 and located at the corresponding infrastructure location is maintained and operated in accordance with the corresponding operational requirement set out in Table 1.

Table 1: Infrastructure and equipment requirements

Site infrastructure and equipment	Operational requirement	Infrastructure location
Generators	<p>The licence holder must operate the following seven diesel (distillate-oil) fired generators to achieve the corresponding output capacity:</p> <ol style="list-style-type: none"> Generator 4 – 2.8 MW (operated as a back-up unit) Generator 5 – 3.4 MW Generator 6 – 3.4 MW Generator 7 – 2.6 MW Generator 8 – 2.6 MW Generator 9 – 2.6 MW Generator 10 – 2.6 MW <p>The licence holder must operate and maintain air filters and temperature probes to the manufacturers specifications.</p>	Generators as represented in Figure 2
Tank Farm	The licence holder must operate and maintain all bunds, concrete hard stands, oil/water separators, sumps, stormwater culverts, containment trenches and associated pipelines to design specifications.	Tank Farm as represented in Figure 2 and Figure 3, Schedule 1

Emissions and discharges

Chemical spills

- The licence holder must, except where storage is prescribed in condition 1, ensure that environmentally hazardous materials are stored in accordance with the code of practice for the storage and handling of dangerous goods.
- The licence holder must immediately recover, or remove and dispose of spills of environmentally hazardous materials outside an engineered containment system.

Contaminated stormwater

- The licence holder must:
 - implement all practical measures to prevent stormwater run-off becoming contaminated by the activities on the premises; and

Department of Water and Environmental Regulation

- (b) treat contaminated or potentially contaminated stormwater as necessary prior to being discharged from the premises¹.

Note 1: The Environmental Protection (Unauthorised Discharges) Regulations 2004 make it an offence to discharge certain materials into the environment.

- 5. The licence holder must undertake the management action specified in Table 2 in the case of an event listed in Table 2.

Table 2: Management actions

Emission point	Event/ action reference	Event	Management action
Oil/ water separators	EA1	Failure or malfunction or abnormal operation period resulting in elevated hydrocarbon sampling from L2	<ol style="list-style-type: none"> 1. Ensure no discharge of waste water is released from oil/ water separator by locking outflow pipe in 'closed' position or transferring contained waste water to an impermeable holding facility; 2. Assess and undertake maintenance or upgrades on the treatment process prior to reloading the separator. 3. Transfer untreated waste water back through the system and re-sample to ensure parameter limits are being achieved. 4. Once parameter sampling limits are achieved, treated waste water may be discharged from the oil/ water separator to the Coalescing Plate Interceptor (CPI) and via the stormwater pipeline to ocean outfall.
Hydrocarbon contaminated wastewater or soil from bunded facilities	EA2	Hydrocarbon spills within bunded structures	<ol style="list-style-type: none"> 1. Transfer all contaminated storm water held within bunds or trenches (that is potentially contaminated with hydrocarbons), and process through an oil/ water separator or an appropriate recycling/ disposal facility.

Point source emissions to air

- 6. The licence holder must ensure that where waste is emitted to air from the emission points in Table 3 and identified on the map of emission points in Schedule 1 (Figure 2 and Figure 3) it is done so in accordance with the conditions of this licence.

Table 3: Point source emission limits to air

Emission point reference	Emission point	Emission point height (m)	Source, including any abatement
A1	Generator 4 exhaust	10	Generator 4 - Allen back-up unit 2.8 MWe

A2	Generator 5 exhaust	12	Generator 5 - Ruston frontline units 3.4 MWe
A3	Generator 6 exhaust	12	Generator 6 - Ruston frontline units 3.4 MWe
A4	Generator 7 exhaust	16	Generator 7 - Wartsila frontline unit 2.6 MW
A5	Generator 8 exhaust	16	Generator 8 - Wartsila frontline unit 2.6 MWe
A6	Generator 9 exhaust	16	Generator 9 - Wartsila frontline unit 2.6 MWe
A7	Generator 10 exhaust	16	Generator 10 - Wartsila frontline unit 2.6 MWe

Emissions to land

7. The licence holder must ensure that where waste is emitted to land from the emission points in Table 4 it is done so in accordance with the conditions of this licence.

Table 4: Emission points to land

Emission point reference	Description	Source including abatement
L1 (See Schedule 1: Maps)	Untreated liquid waste discharge pipelines	1. No untreated liquid waste to be discharged via L1 or L2 emission point to storm water drainage pipeline. 2. Pipelines to be locked at all times, except when tank is under maintenance and/ or contents has been determined (through testing) to meet required parameter levels for hydrocarbons.
L2 and L3 (See Schedule 1: Maps)	Discharge to treated stormwater pipe	1. All waste water discharged from via disk skimmer and coalescing plate interceptor (CPI), prior to discharge.

8. The licence holder must not cause or allow point source emissions to land greater than the limits listed in Table 5

Table 5: Point source emissions limits to land

Emission point reference	Parameter	Limit (including units)	Averaging period
L1, L2 and L3	Hydrocarbons (TRH)	30 mg/L	Spot sample

9. The licence holder must target point source emissions to land at or below the levels specified in Table 6.

Table 6: Point source emission targets to land

Emission point reference	Parameter	Target (including units)	Averaging period
L1, L2 and L3	Hydrocarbons (TRH)	≤15 mg/L	Spot sample

Fugitive emissions

- 10.** The licence holder must use all reasonable and practical measures to prevent and where that is not practicable to minimise dust emissions from the premises.

Noise emissions

- 11.** The licence holder must ensure that noise emitted from the premises does not unreasonably interfere with the health, welfare, convenience, comfort or amenity of any person who is not on the premises

Monitoring

General monitoring

- 12.** The licence holder must ensure that:
- all water samples are collected and preserved in accordance with AS/NZS 5667.1;
 - all wastewater sampling is conducted in accordance with AS/NZS 5667.10;
 - all laboratory samples are submitted to and tested by a laboratory with current NATA accreditation for the parameters being measured.
- 13.** The licence holder must ensure that six monthly monitoring is undertaken at least five months apart.
- 14.** The licence holder must ensure all monitoring equipment used on the premises to comply with the conditions of this licence, is calibrated in accordance with the manufacturer's specifications.
- 15.** The licence holder must, where the requirements for calibration cannot be practicably met, or a discrepancy exists in the interpretation of the requirements, bring these issues to the attention of the CEO accompanied with a report comprising details of any modifications to the methods.

Monitoring of emissions to land

- 16.** The licence holder must undertake the monitoring in Table 7 according to the specifications in that table.

Table 7: Monitoring of point source emissions to land

Emission point reference	Parameter	Units	Frequency
L2 and L3	Hydrocarbons (TRH)	mg/L	Six monthly

Monitoring of inputs and outputs

17. The licence holder must undertake the monitoring in Table 8 according to the specifications in that table

Table 8: Monitoring of inputs and outputs

Input/ Output	Parameter	Units	Averaging period	Frequency
Diesel fuel	Sulphur	ppm or mg/kg	Monthly	Each batch arriving at premises

18. The licence holder must not accept diesel fuel onto the site unless the fuel is less than the limit listed in Table 9

Table 9: Monitoring of diesel inputs

Input	Parameter	Units	Limit (including units)	Frequency
Diesel fuel	Sulphur	ppm or mg/kg	≤10 ppm/ 10 mg/kg	Each batch arriving at premises

Records and reporting

Records

19. The licence holder must record the following information in relation to complaints received by the licence holder (whether received directly from a complainant or forwarded to them by the Department or another party) about any alleged emissions from the premises:
- the name and contact details of the complainant, (if provided);
 - the time and date of the complaint;
 - the complete details of the complaint and any other concerns or other issues raised; and
 - the complete details and dates of any action taken by the licence holder to investigate or respond to any complaint.
20. The licence holder must maintain accurate and auditable books including the following records, information, reports, and data required by this licence:
- the calculation of fees payable in respect of this licence;
 - the works conducted in accordance with condition 19 of this licence;
 - any maintenance of infrastructure that is performed in the course of complying with conditions 1 to 5 of this licence;
 - monitoring programmes undertaken in accordance with conditions 12 to 18 of this licence; and
 - complaints received under condition 19 of this licence.
21. The books specified under condition 20 must:
- be legible;
 - if amended, be amended in such a way that the original version(s) and any subsequent amendments remain legible and are capable of retrieval;

Department of Water and Environmental Regulation

- (c) be retained by the licence holder for the duration of the licence; and
- (d) be available to be produced to an inspector or the CEO as required.

Reporting

- 22.** The licence holder must:
- (a) undertake an audit of their compliance with the conditions of this licence during the preceding annual period, and
 - (b) prepare and submit to the CEO an Annual Audit Compliance Report in the approved form by 1 October each year.
- 23.** The licence holder must:
- (a) prepare an Environmental Report that provides information in accordance with Table 10 for the preceding annual period, and
 - (b) submit that Environmental Report to the CEO by 1 October each year.

Table 10: Environmental reporting requirements

Condition	Requirement	Format
-	Summary of any failure or malfunction of any pollution control equipment and any environmental incidents that have occurred during the annual period and any action taken	None specified
5	Summary of management actions undertaken	None specified
9	Target exceedances	None specified
16	Hydrocarbons (TRH)	None specified
17	Monitoring of inputs and outputs	None specified
18	Monitoring of diesel inputs	None specified
22	Compliance	Annual Audit Compliance Report (AACR)
19	Complaints summary	None specified

- 24.** The licence holder must ensure that the Environmental Report required by condition 23, also contains:
- (a) an assessment of the information contained within the report against previous monitoring results and licence limits and/or targets; and
 - (b) a list of any original monitoring reports submitted to the licence holder from third parties for the annual period and make these reports available on request.

Notification

- 25.** The licence holder must ensure that the parameters listed in Table are notified to the CEO in accordance with the notification requirements of the table.

Table 11: Notification requirements

Condition	Parameter	Notification requirement ¹
8 and 18	Breach of any limit specified in the Licence	Part A: As soon as practicable but no later than 5pm of the next usual working day.
1 to 11	Any failure or malfunction of any pollution control equipment or any incident, which has caused, is causing or may cause pollution	Part B: As soon as practicable
14 and 15	Calibration report	As soon as practicable.

Definitions

In this licence, the terms in Table 12 have the meanings defined.

Table 12: Definitions

Term	Definition
ACN	Australian Company Number
Annual Audit Compliance Report (AACR)	means a report submitted in a format approved by the CEO (relevant guidelines and templates are available on the Department's website).
annual period	a 12 month period commencing from 1 July until 30 June of the immediately following year.
AS/NZS 5667.1	Means the Australian Standard AS/NZS 5667.1 <i>Water Quality – Sampling – Guidance of the Design of sampling programs, sampling techniques and the preservation and handling of samples</i>
AS/NZS 5667.10	Means the Australian Standard AS/NZS 5667.1 <i>Water Quality – Sampling – Guidance on sampling of waste waters</i>
books	has the same meaning given to that term under the EP Act.
CEO	means Chief Executive Officer of the department. “submit to / notify the CEO” (or similar), means either: Director General Department administering the <i>Environmental Protection Act 1986</i> Locked Bag 10 Joondalup DC WA 6919 or: info@dwer.wa.gov.au
department; DWER	means the department established under section 35 of the <i>Public Sector Management Act 1994</i> (WA) and designated as responsible for the administration of the EP Act, which includes Part V Division 3.
discharge	has the same meaning given to that term under the EP Act.
emission	has the same meaning given to that term under the EP Act.
EP Act	<i>Environmental Protection Act 1986</i> (WA)
EP Regulations	<i>Environmental Protection Regulations 1987</i> (WA)
licence	refers to this document, which evidences the grant of a licence by the CEO under section 57 of the EP Act, subject to the specified conditions contained within.
licence holder	refers to the occupier of the premises, being the person specified on the front of the licence as the person to whom this licence has been

Term	Definition
	granted.
premises	refers to the premises to which this licence applies, as specified at the front of this licence and as shown on the premises map in Schedule 1 to this licence.
prescribed premises	has the same meaning given to that term under the EP Act.
waste	has the same meaning given to that term under the EP Act.

END OF CONDITIONS

Schedule 1: Maps

Premises map

The boundary of the prescribed premises is shown in the map below (Figure 1).



Figure 1: Map of the boundary of the prescribed premises

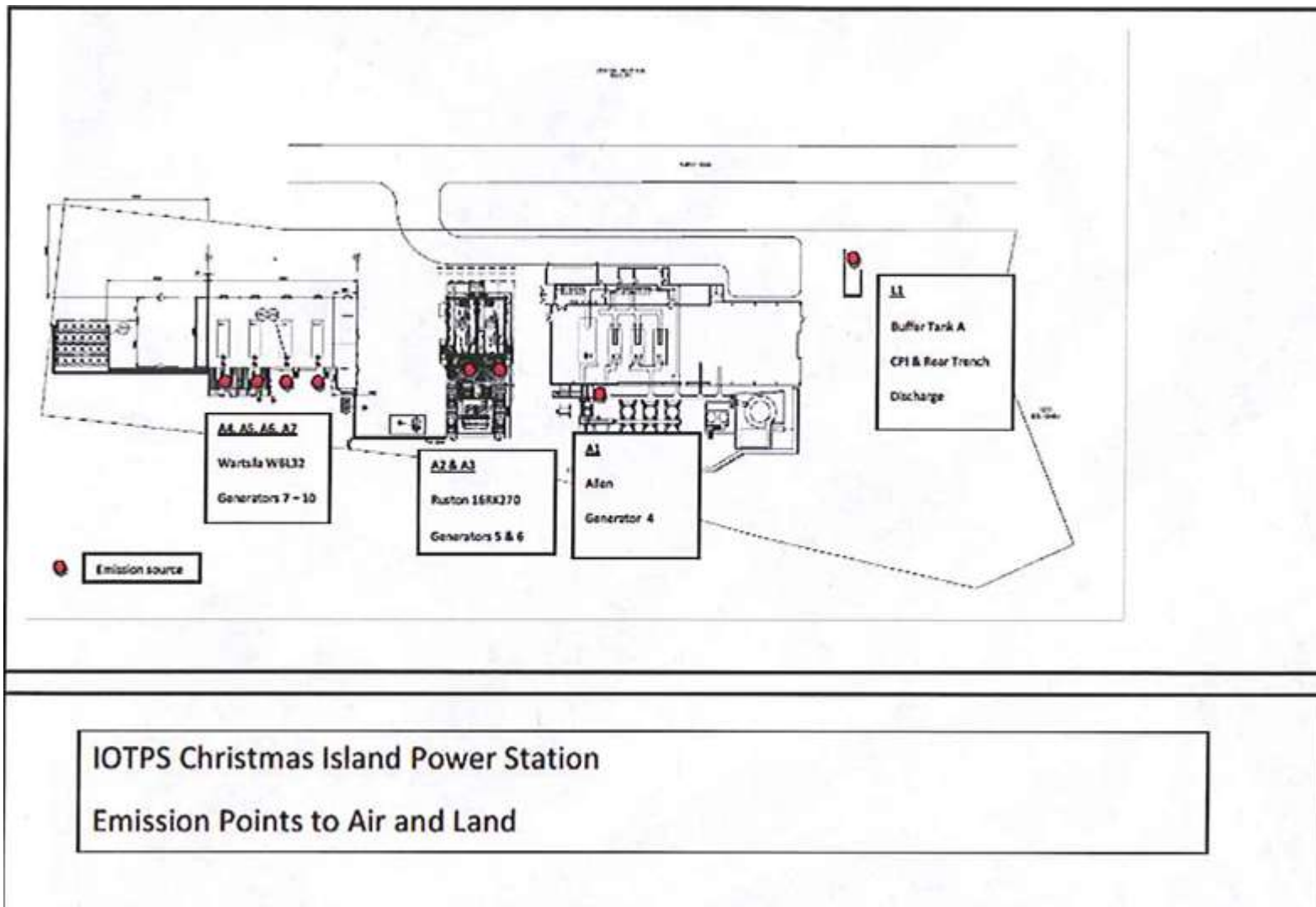

Figure 2: Map of emissions and monitoring points

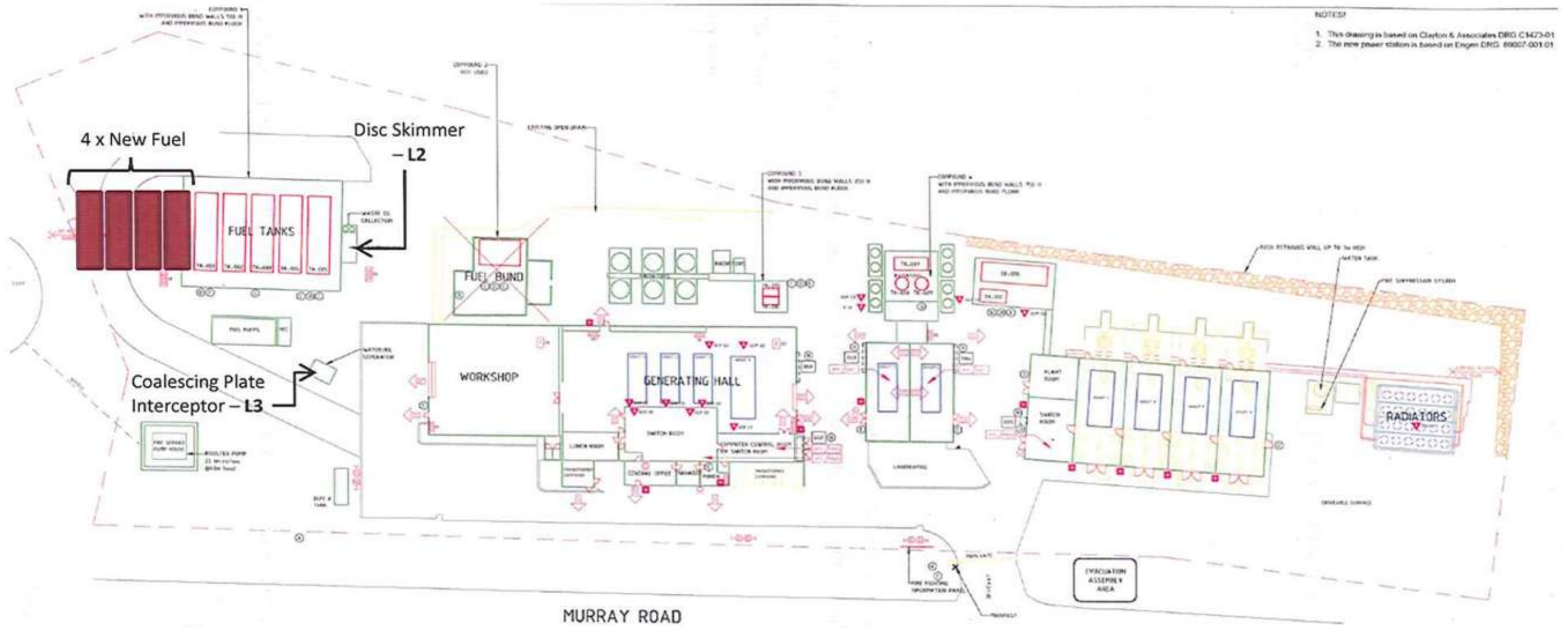

Figure 3: Monitoring points

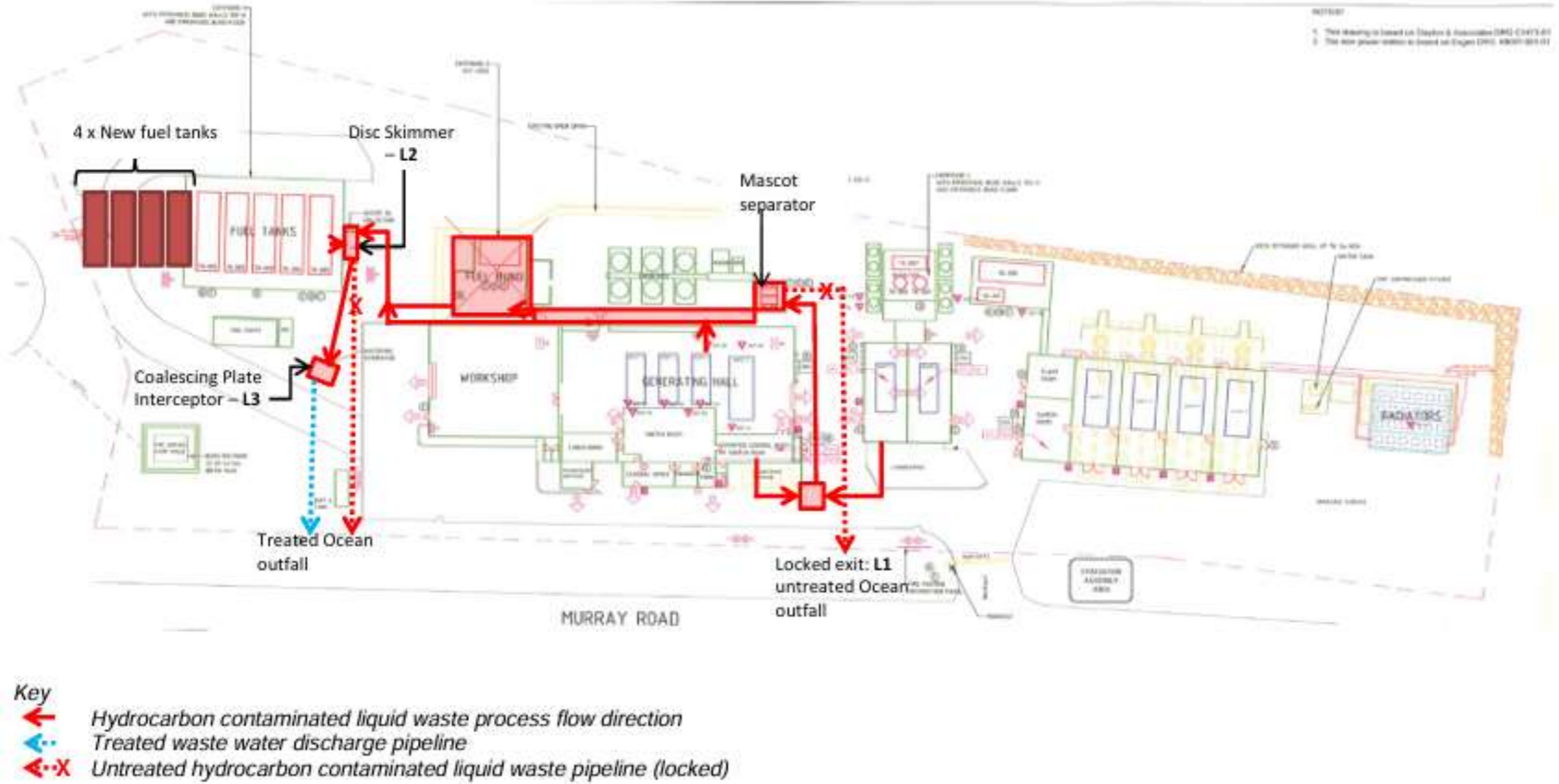

Figure 4: Process flow diagram of hydrocarbon management