



| | |
|------------------------------------|---|
| Licence number | L6107/1967/17 |
| Licence holder | CSBP Limited |
| ACN | 008 668 371 |
| Registered business address | Level 14, Tower 2 Brookfield Place 123 St Georges Terrace PERTH WA 6000 |
| DWER file number | DWERVT3889 & INS-0001275 |
| Duration | 31/07/2011 to 30/07/2031 |
| Date of amendment | 23 April 2026 |
| Premises details | CSBP Limited Kwinana KWINANA BEACH WA 6167 Legal description - Part of Lot 20 on Diagram 78086, Volume 1918 / Folio 244 and Part of Lot 18 on Plan 17311, Volume 2058 / Folio 310 As defined by the map and coordinates in Schedule 1 |

| Prescribed premises category description (Schedule 1, <i>Environmental Protection Regulations 1987</i>) | Assessed capacity |
|---|----------------------------|
| Category 31: Chemical manufacturing | 3,712,000 tonnes per annum |
| Category 61: Liquid waste facility | 10,000 tonnes per annum |
| Category 61A: Solid waste facility | 10,000 tonnes per annum |
| Category 75: Chemical blending or mixing not causing discharge | 100,000 tonnes per annum |

This amended licence is granted to the licence holder, subject to the attached conditions, on 23 April 2026 by:

MANAGER, HEAVY INDUSTRIES

an officer delegated under section 20 of the *Environmental Protection Act 1986* (WA)

[L6107/1967/17 \(date of amendment: 23/04/2026\)](#)

Licence history

| Date | Reference number | Summary of changes |
|------------|------------------|--|
| 29/11/2009 | L6107/1967/16 | Licence re-issue |
| 14/07/2011 | L6107/1967/17 | Licence re-issue |
| 29/04/2016 | L6107/1967/17 | Department initiated amendment in accordance with section 59(1)(k) of the <i>Environmental Protection Act 1986</i> to amend the duration of the licence. |
| 30/06/2016 | L6107/1967/17 | Licence amended with the revised SDOOL discharge limits. |
| 06/02/2017 | L6107/1967/17 | Amendment Notice 1: Change of Registered Business Address. |
| 01/03/2017 | L6107/1967/17 | Amendment Notice 2: authorisation for construction and operation of the ANE Plant and an additional category 75 in the licence. |
| 22/01/2018 | L6107/1967/17 | Amendment Notice 3: Construction and operation of a Water Treatment Plant, remove Mn and Fe limits and add Quarter to the definitions re: condition A4(a)(ii). |
| 26/04/2018 | L6107/1967/17 | Amendment Notice 4: Licence holder initiated amendment to replace 'three month period' with 'Quarter' to conditions G2(a)(viii), A5(a)(ii) and A6(a). |
| 02/12/2019 | L6107/1967/17 | Amended Licence: Amendment and consolidation of previous amendments into a new Amended Licence. |
| 01/07/2020 | L6107/1967/17 | Amended Licence: Licence holder initiated amendment to add conditions to control Controlled Waste acceptance. |
| 26/03/2021 | L6107/1967/17 | Amended Licence: CEO initiated amendment to correct a controlled waste category for ammonium nitrate emulsion. |
| 23/04/2026 | L6107/1967/17 | Amended Licence: Licence holder-initiated amendment to consolidate reporting alongside other minor wording and timeframe amendments. |

Interpretation

In this licence:

- (a) the words 'including', 'includes' and 'include' in conditions mean "including but not limited to", and similar, as appropriate;
- (b) where any word or phrase is given a defined meaning, any other part of speech or other grammatical form of that word or phrase has a corresponding meaning;
- (c) where tables are used in a condition, each row in a table constitutes a separate condition;
- (d) any reference to an Australian or other standard, guideline, or code of practice in this licence:
 - (i) if dated, refers to that particular version; and
 - (ii) if not dated, refers to the latest version and therefore may be subject to change over time;
- (e) unless specified otherwise, any reference to a section of an Act refers to that section of the EP Act; and
- (f) unless specified otherwise, all definitions are in accordance with the EP Act.

NOTE: This licence requires specific conditions to be met but does not provide any implied authorisation for other emissions, discharges, or activities not specified in this licence.

Licence conditions

The licence holder must ensure that the following conditions are complied with:

Infrastructure and equipment

Stockpile management

1. The licence holder must at all time store raw materials and fertilisers (except phosphate rock) upon a sealed hardstand and under a rainproof covering.

Emissions and discharges

Marine discharges

2. The licence holder must ensure that all process wastewater only be discharged to the environment via the:
 - (a) diffuser at the end of the submarine pipeline to Cockburn Sound,
 - (b) SDOOL; or
 - (c) emergency beach outfall to Cockburn Sound.
3. The licence holder must notify the CEO before 5pm on the next usual business day following any discharge of wastewater other than stormwater via the emergency beach outfall to Cockburn Sound.

Monitoring program for discharge via the submarine pipeline or to SDOOL

4. The licence holder must:
 - (a) collect samples from the effluent stream, that is discharged in accordance with Condition 2 (a) or (b), where the samples are bulked to form a 24-hour composite sample which is representative of the effluent discharged during those 24 hours;
 - (b) that no more than ten 24-hour composite samples per year are missed due to error or malfunction; and
 - (c) ensure that no more than two consecutive 24-hour composite samples are missed.
5. The licence holder must determine the discharge of the effluent stream, as required by Condition 2 (a) or (b), in cubic metres per day, on a daily basis.
6. The licence holder must determine the pH and concentration of Total Inorganic Nitrogen, Orthophosphate, Aluminium, Arsenic (inorganic), Cadmium, Chromium, Cobalt, Copper, Free Cyanide, Fluoride, Iron, Lead, Manganese, MDEA, Mercury, Molybdenum, Nickel, Vanadium and Zinc, for each sample bulked on a daily basis, as required by Condition 4. For this purpose, Total Inorganic Nitrogen is defined as the combination of ammonium ion nitrogen (NH₄⁺) and nitrate nitrogen (NO₃⁻).

Monitoring program for emergency marine discharges

7. The licence holder must, in the event of a discharge via the beach outfall, conduct the following monitoring program in order to estimate the mass load and concentration of substances entering Cockburn Sound via the beach outfall:
 - (a) representative samples shall be taken of the discharge;

Department of Water and Environmental Regulation

- (b) determine the parameters as specified in Condition 6; and
- (c) a record of start and stop times of wastewater discharge via the beach outfall shall be kept.

Marine discharge limits

8. The licence holder must ensure that the daily concentrations and 90 day rolling average daily loads of substances in effluent discharged in accordance with Condition 2 shall not exceed the limits specified in Table 1.

Table 1: Discharge limits to Cockburn Sound or SDOOL

| Parameter | Daily concentration limit for discharge to Cockburn Sound / Target concentration for discharge to SDOOL | 90 day rolling average daily load limit for both the discharge to Cockburn Sound and SDOOL |
|--------------------------|--|--|
| | mg/L | kg/day |
| Total Inorganic Nitrogen | - | 200 |
| Orthophosphate | - | 100 |
| Arsenic (Inorganic) | 0.1 | - |
| Cadmium | 0.036 | - |
| Copper | 0.285 | - |
| Free cyanide | 0.1 | - |
| Fluoride | - | 54 |
| Mercury | 0.0014 | 0.020 |
| Molybdenum | 0.25 | - |
| MDEA | 16.0 | - |
| Zinc | 2.25 | - |

9. The licence holder must ensure that effluent discharged to Cockburn Sound or to the SDOOL must be between 6.0 and 9.0 pH units except for one day in the month when the pH may be between 4.0 and 10.0 as measured in samples collected in accordance with condition 4.

Air emissions**Air pollution control conditions**

10. The licence holder must ensure that waste gases shall only be emitted to the environment through the emission points shown in Schedule 1 and listed in Schedule 2.

Nitrogen oxides start-up limitations

11. The licence holder must maintain a minimum of one hour between the startup of each Nitric Acid Plant.
12. The licence holder must ensure that the Nitric Acid Plants do not start-up unless a monitoring system is in place to analyse start-up NO_x emissions.
13. The licence holder must ensure that a record shall be kept indicating the time, prevailing wind speed and direction, and the maximum half-hourly average NO_x concentration in g/m³ during each start-up of each Nitric Acid Plant.

Air emissions monitoring

14. Where continuous gaseous emission analysers are required by conditions of this licence, the licence holder must ensure that reliable emissions monitoring data is obtained and recorded for:
 - (a) greater than 90 percent of the manufacturing plant's stable operating time in every calendar month period; and
 - (b) greater than 95 percent of the manufacturing plant's stable operating time in any 12 consecutive calendar months.
15. The licence holder must monitor emissions:
 - (a) from each discharge point;
 - (b) at the corresponding monitoring location;
 - (c) for the corresponding parameter;
 - (d) at the corresponding frequency;
 - (e) for the corresponding averaging period;
 - (f) in the corresponding unit; and
 - (g) using the corresponding method,as set out in Table 2.

Table 2: Air emissions monitoring

| Discharge point (Schedule 2) | Parameter | Frequency ¹ | Averaging period | Unit ² | Method |
|---|--------------------------------------|---|------------------|-------------------|---|
| Nitric Acid Plant 1, Nitric Acid Plant 2 & Nitric Acid Plant 3 stacks | NO _x concentration | Continuous | 1 hour | g/m ³ | CEMS |
| | NO _x mass emission rate | | | g/s | |
| SMP Scrubber stack/RTO stack ³ | Hydrofluoric acid concentration | Twice annually with samples being taken at least 2 months apart | N/A | g/m ³ | Relevant USEPA or equivalent NATA accredited method |
| | Hydrofluoric acid mass emission rate | | | g/s | |
| Granulation Plant | Hydrofluoric acid concentration | Twice annually with samples being taken at least 3 months apart | N/A | g/m ³ | |
| | Hydrofluoric acid mass emission rate | | | g/s | |
| | Ammonia concentration | | | g/m ³ | |
| | Ammonia mass emission rate | | | g/s | |
| Ammonia Plant Primary Reformed stack and Auxiliary Boiler stack | NO _x concentration | Quarterly, when the plant is operating | 1 hour | mg/m ³ | |
| | NO _x mass emission rate | | | g/s | |
| Ammonium Nitrate Prilling Plant scrubber stack | Total particulate concentration | Twice annually at least 5 months apart | 1 hour | g/m ³ | |
| | Total particulate mass emission rate | | | g/s | |

Note 1: Monitoring is not required to occur where the plant containing the discharge point is offline for the entire annual period, such as during periods of care and maintenance. Should the plant recommence operation within the final two months of the annual period, at least one monitoring event must be undertaken as soon as practicable following recommencement of operation.

Note 2: All units are referenced to STP on a dry basis

Note 3: Whichever discharge point is in use at the time of planned sampling

- 16.** The licence holder must record the results of all monitoring activity required by condition 15.

Air emission limits

- 17.** The licence holder must ensure that emissions from the discharge point listed in Table 3 for the corresponding parameter do not exceed the corresponding limit when monitored in accordance with condition 15.

Table 3: Air emission limits

| Discharge point (Schedule 2) | Parameter | Limit |
|---|--|--------------------------|
| Nitric Acid Plant 1, Nitric Acid Plant 2 & Nitric Acid Plant 3 stacks | Hourly average NO _x concentration during operation ¹ | 0.41 g/m ³ |
| | Half hourly average NO _x concentration during start-up | 2.0 g/m ³ |
| Ammonium Nitrate Prilling Plant Scrubber stack | Total particulate concentration | 0.05 g/m ³ |
| SMP Scrubber stack stack ² , RTO stack ² & Granulation Plant Scrubber stack | Hydrofluoric acid concentration | 0.05 g/m ³ |
| | Hydrofluoric acid mass emission expressed as fluoride | 2630 kilograms per month |
| Granulation Plant Scrubber stack | Ammonia concentration | 1.0 g/m ³ |

Note 1: Not including the half-hour period immediately following start-up.

Note 2: As determined for whichever stack is in operation at the time of sampling

Groundwater monitoring program

18. The licence holder must ensure that all groundwater monitoring activities, including the collection, preservation, transportation, and analysis of water samples required by any conditions of this licence, are conducted in accordance with the latest department approved CSBP Groundwater Operating Strategy.
19. The licence holder must prepare an annual Borefield Monitoring Review, in accordance with the CSBP Groundwater Operating Strategy referenced in condition 18. The report must include:
 - (a) Contour maps derived from measurements and samples taken from the monitoring bores detailed in the Operating Strategy; and
 - (b) All data required by condition 18.

Spill management

20. The licence holder must contain and recover, or absorb and dispose of, liquid resulting from spills or leaks of chemicals including fuel, oil or other hydrocarbons, whether inside or outside secondary containment compound(s).

Quality assurance program

21. The licence holder must maintain a current Quality Assurance Program (QAP), which describes in detail the sampling methodology, calibration, instrumentation and calculation procedures implemented to satisfy any monitoring requirement contained in the conditions of this licence. The QAP may refer to other published methods.
22. The licence holder must ensure that all monitoring equipment, required by any licence condition, is calibrated in accordance with the manufacturer's requirements or an appropriate Australian, International or standard of another country.
23. The licence holder must ensure that the QAP, referred to condition 21, shall be amended to reflect any alterations or additions to the calibration, instrumentation and calculation procedures being adopted in practice by the licence holder within three months of that change occurring.

24. The licence holder must provide the CEO with an updated tabulated list of all QAP procedures required for accurate reporting pursuant to conditions of this licence, the condition to which they relate and the most recent revision date in each annual report.

Waste acceptance control conditions

25. The licence holder must only accept onto the premises waste of a waste type that meets the corresponding acceptance specification set out in Table 4, and which does not exceed the corresponding rate at which waste is received.

Table 4: Waste acceptance criteria

| Waste type | Controlled Waste Category Group | Rate at which waste is received | Acceptance specification |
|--|---------------------------------|---|---|
| Acidic solutions | B100 | Combined total of no more than 10,000 tonnes per annual period of liquid waste and 10,000 tonnes per annual period of solid waste | Delivered to the premises either by tanker or in intermediate bulk containers (IBCs), drums, or other containers. |
| Non toxic salts | D300 | | |
| Highly reactive chemicals not otherwise specified | E130 | | |
| Non-halogenated organic solvents | G110 | | |
| Waste mineral oils unfit for their intended purpose | J100 | | |
| Food and beverage processing waste | K200 | | |
| Car and truck wash waters | L100 | | |
| Industrial wash waters contaminated with a controlled waste | L150 | | |
| Non-halogenated organic chemicals | M130 | | |
| Containers or drums contaminated with residues of a controlled waste | N100 | | |

26. Where waste does not meet the waste acceptance criteria set out in condition 25, the licence holder must:
- (a) reject the waste; and
 - (b) record the details of the:
 - (i) waste (type and description);
 - (ii) source of the waste load;
 - (iii) name of the waste carrier;
 - (iv) registration number of the delivery vehicle;
 - (v) date that the waste load was rejected; and

Department of Water and Environmental Regulation

- (c) maintain accurate and auditable records of all waste loads rejected from the premises.
- 27.** The licence holder must ensure that where waste does not meet the waste acceptance criteria set out in condition 25, it is removed from the premises by the delivery vehicle or, where that is not possible, stored in a quarantined storage area or container and removed to an appropriately authorised facility as soon as practicable.
- 28.** The licence holder must record the total amount of waste accepted onto the premises, for each waste type listed in Table 4, in tonnes over the annual period.

Records and reporting

Records

- 29.** The licence holder must record the following information in relation to complaints received by the licence holder (whether received directly from a complainant or forwarded to them by the Department or another party) about any alleged emissions from the premises:
- (a) the name and contact details of the complainant, (if provided);
 - (b) the time and date of the complaint;
 - (c) the complete details of the complaint and any other concerns or other issues raised; and
 - (d) the complete details and dates of any action taken by the licence holder to investigate or respond to any complaint.
- 30.** The licence holder must maintain accurate and auditable books including the following records, information, reports, and data required by this licence:
- (a) the calculation of fees payable in respect of this licence;
 - (b) monitoring programmes undertaken in accordance with conditions 4, 7, 15 and 18 of this licence; and
 - (c) complaints received under condition 29 of this licence.
- 31.** The books specified under condition 30 must:
- (a) be legible;
 - (b) if amended, be amended in such a way that the original version(s) and any subsequent amendments remain legible and are capable of retrieval;
 - (c) be retained by the licence holder for the duration of the licence; and
 - (d) be available to be produced to an inspector or the CEO as required.

Reporting

- 32.** The licence holder must:
- (a) undertake an audit of their compliance with the conditions of this licence during the preceding annual period, and
 - (b) prepare and submit to the CEO an Annual Audit Compliance Report in the approved form by 30 September each year.

Department of Water and Environmental Regulation

33. The licence holder must:
- prepare an Environmental Report that provides information in accordance with Table 5 for the preceding annual period, and
 - submit that Environmental Report to the CEO by 30 September each year.

Table 5: Environmental reporting requirements

| Condition | Requirement |
|-------------|---|
| 24 | <p>Quality Assurance Program (QAP)</p> <ul style="list-style-type: none"> updated tabular list of all QAP procedures required for accurate reporting pursuant to conditions of this licence, the condition to which they relate and the most recent revision date in each annual report. |
| 6 | <p>Marine Pollution Control:</p> <p>Monitoring program for discharge via the submarine pipeline or to SDOOL:</p> <ul style="list-style-type: none"> provide average wastewater data for each month in accordance with condition 6. |
| 7 | <p>Marine Pollution Control:</p> <p>Monitoring program for emergency marine discharges, including:</p> <ol style="list-style-type: none"> occurrence/s of any emergency wastewater discharges to Cockburn Sound via the Beach outfall; and summary of any limits exceeded during the annual period. |
| 15, 16 & 17 | <p>Air pollution control emission monitoring requirements:</p> <ol style="list-style-type: none"> summary of continuous monitoring of NO_x emissions data from the integrated Nitric Acid and Ammonium Nitrate Plants; summary of hydrofluoric acid data for the Superphosphate and Granulation Plants; summary of ammonia data for the Granulation Plant; summary of the NO_x data for the Ammonia Plant; summary of total particulates data for the 2008 Ammonia Nitrate Prilling Plant; and summary of any plant and equipment offline for care and maintenance during the reporting period. <p>Third party monitoring reports used to determine the quality and/or nature of waste gases discharged, must also include the following information:</p> <ol style="list-style-type: none"> density at stack temperature; moisture content; total volume flow rate at exit temperature; exit temperature; and production rate through the relevant item of equipment from which the discharge originates, percent of maximum capacity and other notable operational circumstances likely to affect discharges from the associated item. |
| 19 | <p>Groundwater Monitoring Program</p> <ul style="list-style-type: none"> an annual Borefield Monitoring Review in accordance with the CSBP Groundwater Operating Strategy |
| 28 | <p>Waste Acceptance Control</p> <ul style="list-style-type: none"> total amount and type of waste accepted onto the premises. |
| 29 | <p>Summary of any complaints received.</p> |

Department of Water and Environmental Regulation

- 34.** The licence holder must ensure that any continuous atmospheric discharge data submitted in accordance with the conditions of this licence is computer readable and shall be:
- (a) In time-series hourly-averaged listings; and
 - (b) The time mark in hourly-averaged continuous data shall refer to the data collected in the hour prior to the time mark.
- 35.** The licence holder must include with submitted data all relevant targets and discharge limits associated with each substance that is required to be monitored by a condition of this licence.
- 36.** The licence holder must, for the practical purposes of reporting monitoring results, not wait for analytical results that have a long turn-around time where, in such cases, the licence holder should annotate a report to the effect that certain results will be provided in the next sequential report.

Target exceedance reporting

- 37.** The licence holder must notify the CEO before 5pm on the next usual business day after becoming aware that any monitoring result has exceeded a target or a limit for a waste discharge specified in any condition of this licence.
- 38.** The licence holder must provide a non-conformance report to the CEO where any monitoring results are in excess of the limits specified in any condition of this Licence within 14 usual business days of that exceedance becoming known, where the exceedance report shall contain:
- (a) the amount by which the limit was exceeded, supported by relevant monitoring data;
 - (b) reasons for the emission levels being in excess of the limits; and
 - (c) an outline of corrective action taken by the licence holder to ensure that emission levels are maintained below the limits, where applicable.
- 39.** The licence holder must provide a detailed report to the CEO of the outcome of internal investigations by the licence holder where any exceedance warrants further investigation, so determined by the CEO, within a time period so determined by the CEO.

Definitions

In this licence, the terms in Table 6 have the meanings defined.

Table 6: Definitions

| Term | Definition |
|---------------------------------------|---|
| ACN | Australian Company Number |
| Annual Audit Compliance Report (AACR) | means a report submitted in a format approved by the CEO (relevant guidelines and templates are available on the Department's website). |
| annual period | a 12-month period commencing from 1 July until 30 June of the immediately following year. |
| annually | means a 12-month period |
| ANE | Ammonium Nitrate Emulsion |
| books | has the same meaning given to that term under the EP Act. |
| Care and maintenance | means an operational status in which a piece of equipment or process is temporarily suspended, but is kept in a safe, stable, and compliant condition so that it can be restarted in the future. |
| CEMS | Means continuous emissions monitoring system |
| CEO | means Chief Executive Officer of the department. "submit to / notify the CEO" (or similar), means either: Director General Department administering the <i>Environmental Protection Act 1986</i> Locked Bag 10 Joondalup DC WA 6919 or: info@dwer.wa.gov.au |
| Controlled waste | as defined in the Controlled Waste Regulations. |
| Controlled Waste Category Group | as defined in the controlled waste category list available on the Department's website. |
| Controlled Waste Regulations | meaning <i>Environmental Protection (Controlled Waste) Regulations 2004 (WA)</i> . |
| Delivery vehicle | meaning the vehicle in which the waste material was delivered. |
| department; DWER | means the department established under section 35 of the <i>Public Sector Management Act 1994 (WA)</i> and designated as responsible for the administration of the EP Act, which includes Part V Division 3. |
| discharge | has the same meaning given to that term under the EP Act. |

| Term | Definition |
|-------------------------------|--|
| emission | has the same meaning given to that term under the EP Act. |
| EP Act | <i>Environmental Protection Act 1986 (WA)</i> |
| EP Regulations | <i>Environmental Protection Regulations 1987 (WA)</i> |
| g/m ³ | meaning grams per cubic metre, expressed at 0 degrees Celsius and 1.0 atmosphere pressure (101.325 kilopascals) |
| g/s | meaning grams per second. |
| kg/day | meaning kilograms per day. |
| KWRP pipeline | meaning the Water Corporation operated Kwinana Water Reclamation Plant pipeline for supply of reclaimed water to industry. |
| licence | refers to this document, which evidences the grant of a licence by the CEO under section 57 of the EP Act, subject to the specified conditions contained within. |
| licence holder | refers to the occupier of the premises, being the person specified on the front of the licence as the person to whom this licence has been granted. |
| m/s | meaning metres per second. |
| mg/m ³ | meaning milligrams per cubic metre |
| mg/L | meaning milligrams per litre. |
| MDEA | methyl diethanolamine |
| NO _x concentration | meaning the total combined concentration of nitric oxide and nitrogen dioxide expressed as nitrogen dioxide. |
| premises | refers to the premises to which this licence applies, as specified at the front of this licence and as shown on the premises map (Figure 1) in Schedule 1 to this licence. |
| prescribed premises | has the same meaning given to that term under the EP Act. |
| QAP | Quality Assurance Program |
| Quarterly | meaning a three month period of time commencing on either 1 January, 1 April, 1 July or 1 October. |
| reliable data | meaning data which meets acceptable quality criteria, verified by calibration procedures and detailed in the QAP. |
| RTO | Regenerative Thermal Oxidiser |
| SCR | Selective Catalytic Reductor |

| Term | Definition |
|--------------------|--|
| SDOOL | meaning the Water Corporation operated Sepia Depression Ocean Outlet Landline. |
| SMP | Superphosphate Manufacturing Plant |
| stack test | meaning a representative sample taken at normal operating conditions. |
| start-up | with reference to the integrated Ammonium Nitrate – Nitric Acid Plant means from when the reactors are 'lit-off' to when ammonia is introduced to the SCR. |
| STP on a dry basis | Meaning Standard Temperature and Pressure (0 degrees Celsius and 1.0 atmosphere pressure / 101.325 kilopascals), dry (corrected to exclude water vapour, or as defined by the relevant method) |
| USEPA Method 5 | meaning United States Environmental Protection Authority Test Method 5 – procedure for determining particulate matter emissions from stationary sources. |
| usual business day | meaning Monday to Friday excluding public holidays. |
| waste | has the same meaning given to that term under the EP Act. |
| waste type | meaning waste types identified in Schedule 1 of the <i>Controlled Waste Regulations 2004</i> . |

END OF CONDITIONS

Schedule 1: Maps

Premises map

The boundary of the prescribed premises is shown in the map below (Figure 1).

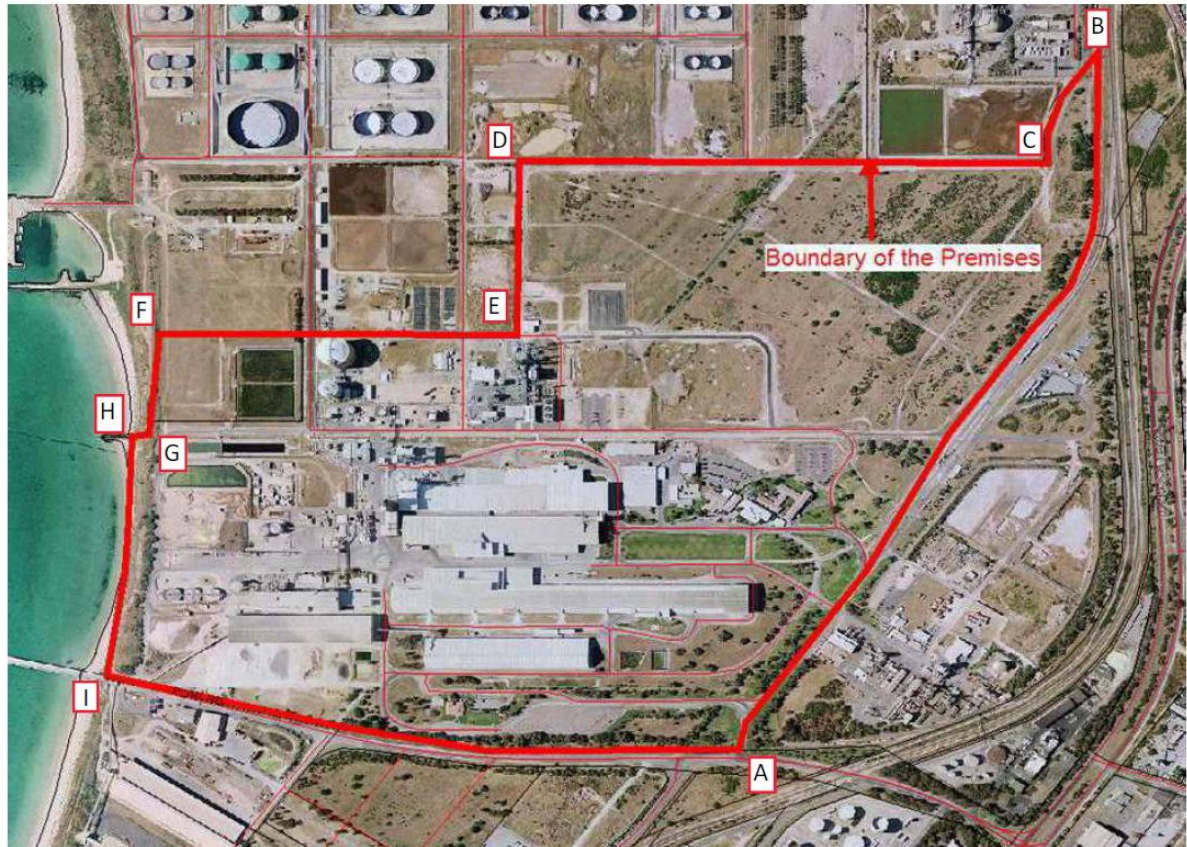

Figure 1: Map of the boundary of the prescribed premises

Coordinates of the points shown in figure above (GDA94-MGA Zone 50):

| Point | X | Y |
|-------|--------|---------|
| A | 384141 | 6431978 |
| B | 384679 | 6433260 |
| C | 384601 | 6433066 |
| D | 383785 | 6433041 |
| E | 383782 | 6432738 |
| F | 383231 | 6432731 |
| G | 383206 | 6432562 |
| H | 383181 | 6432531 |
| I | 383137 | 6432090 |

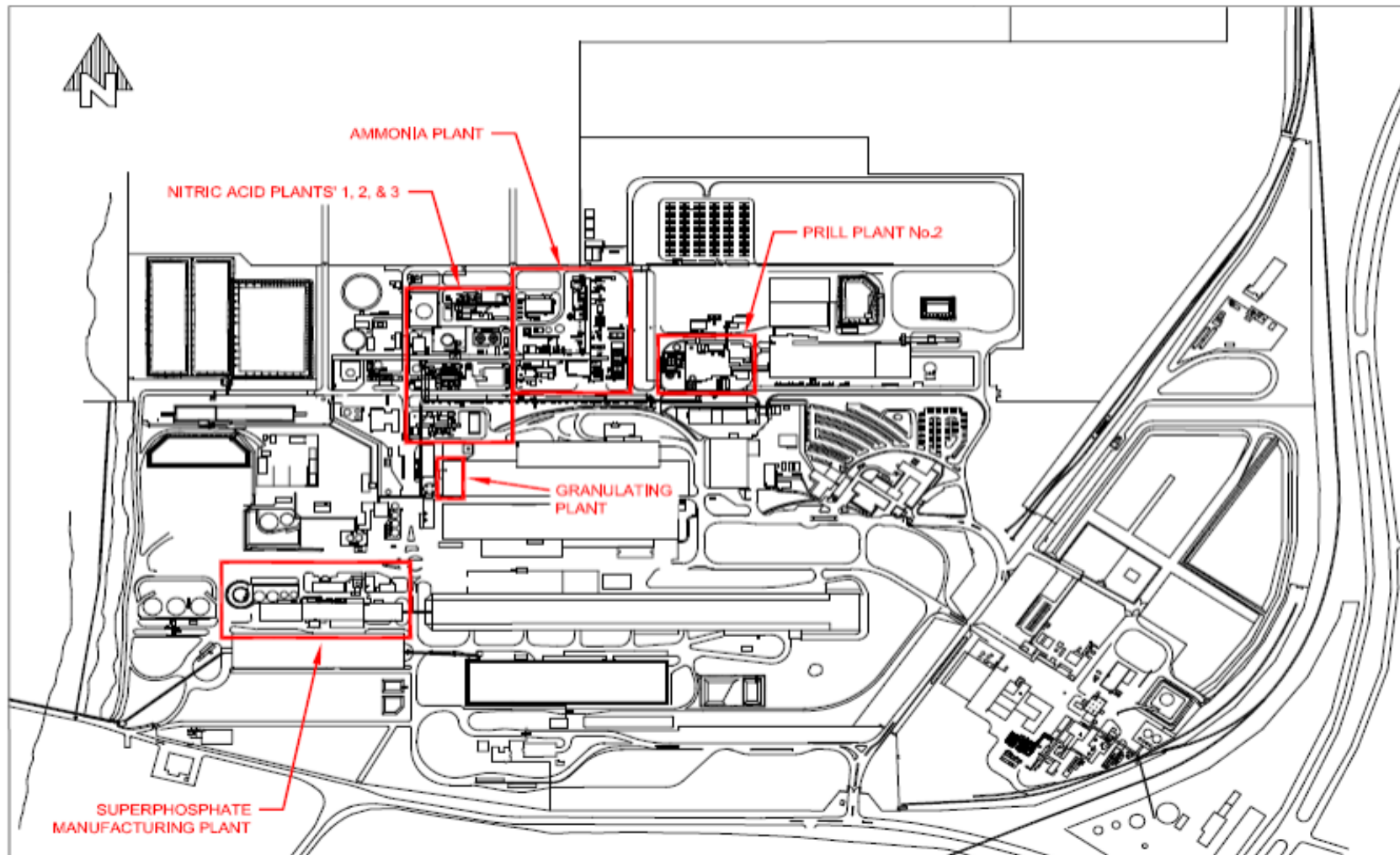

Figure 2: Oversight plan of the premises with five subprocesses marked

L6107/1967/17 (date of amendment: 23 April 2026)

IR-T06 Licence template (v10.0) (May 2024)

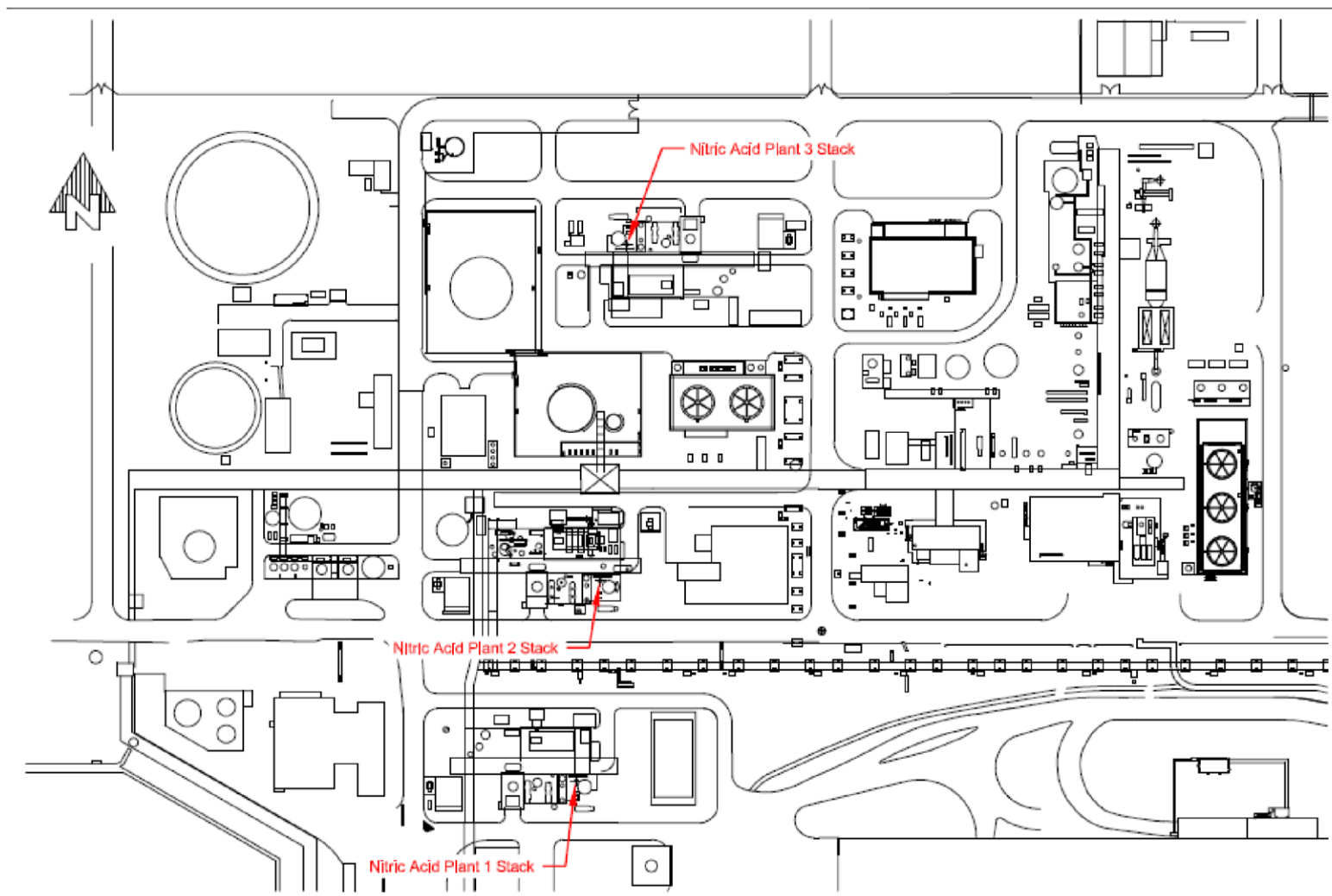

Figure 3: Map of the Nitric Acid Plants discharge points

L6107/1967/17 (date of amendment: 23 April 2026)

IR-T06 Licence template (v10.0) (May 2024)

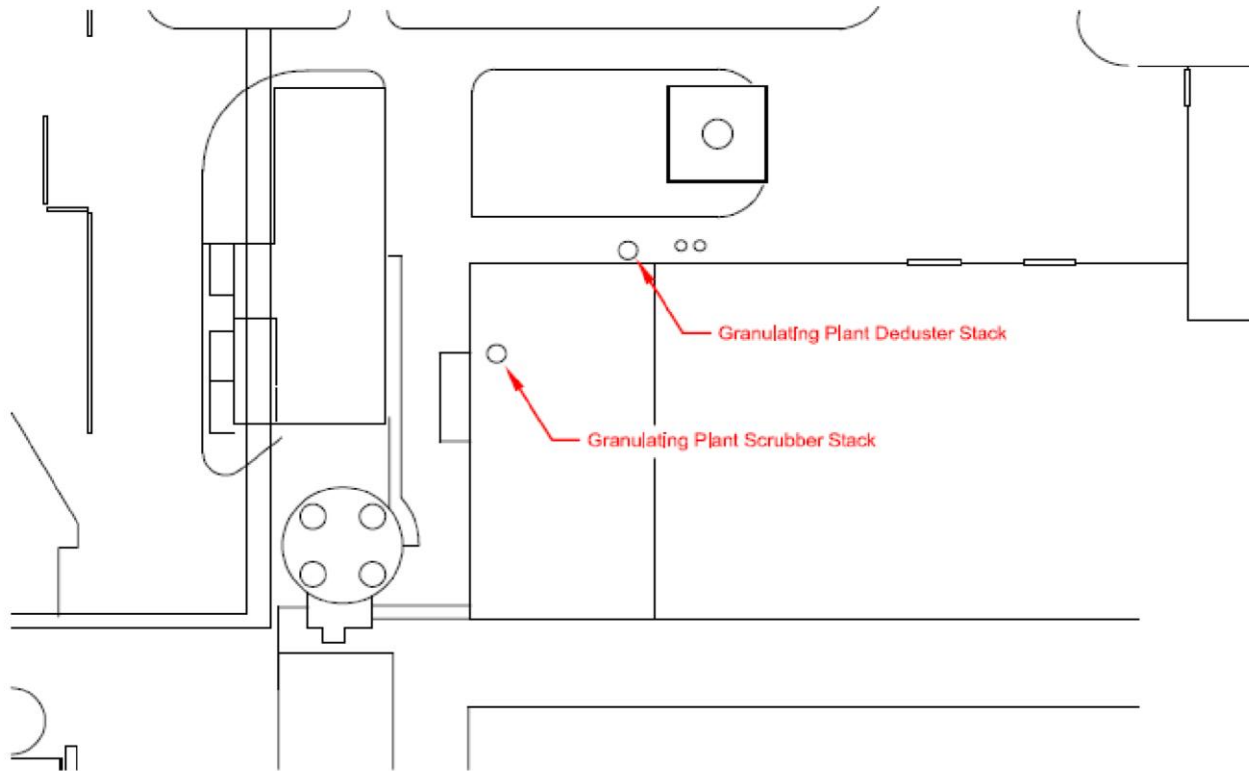

Figure 4: Map of the Granulating Plant discharge points

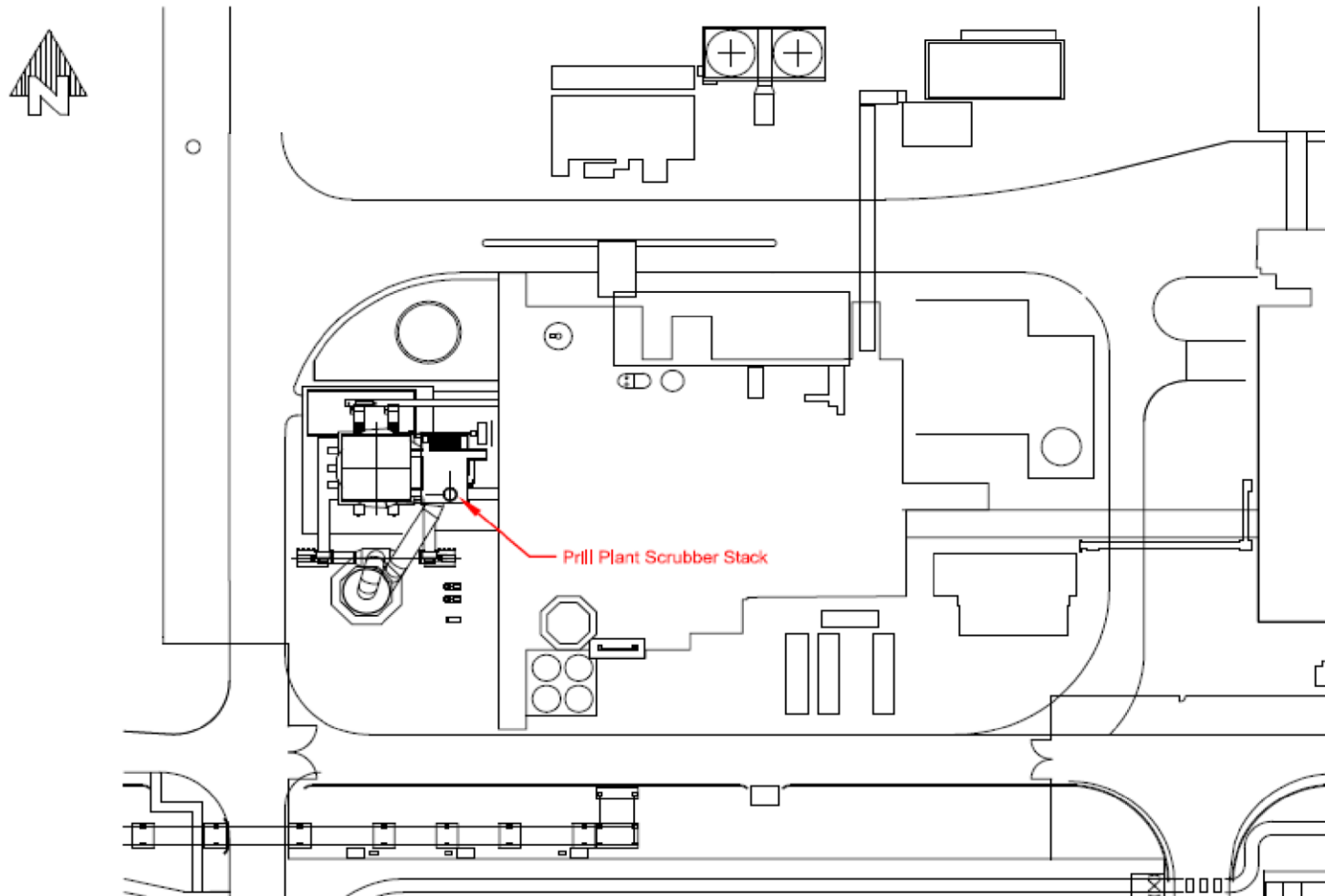

Figure 5: Map of the 2008 Ammonium Nitrate Prilling Plant discharge points

L6107/1967/17 (date of amendment: 23 April 2026)

IR-T06 Licence template (v10.0) (May 2024)

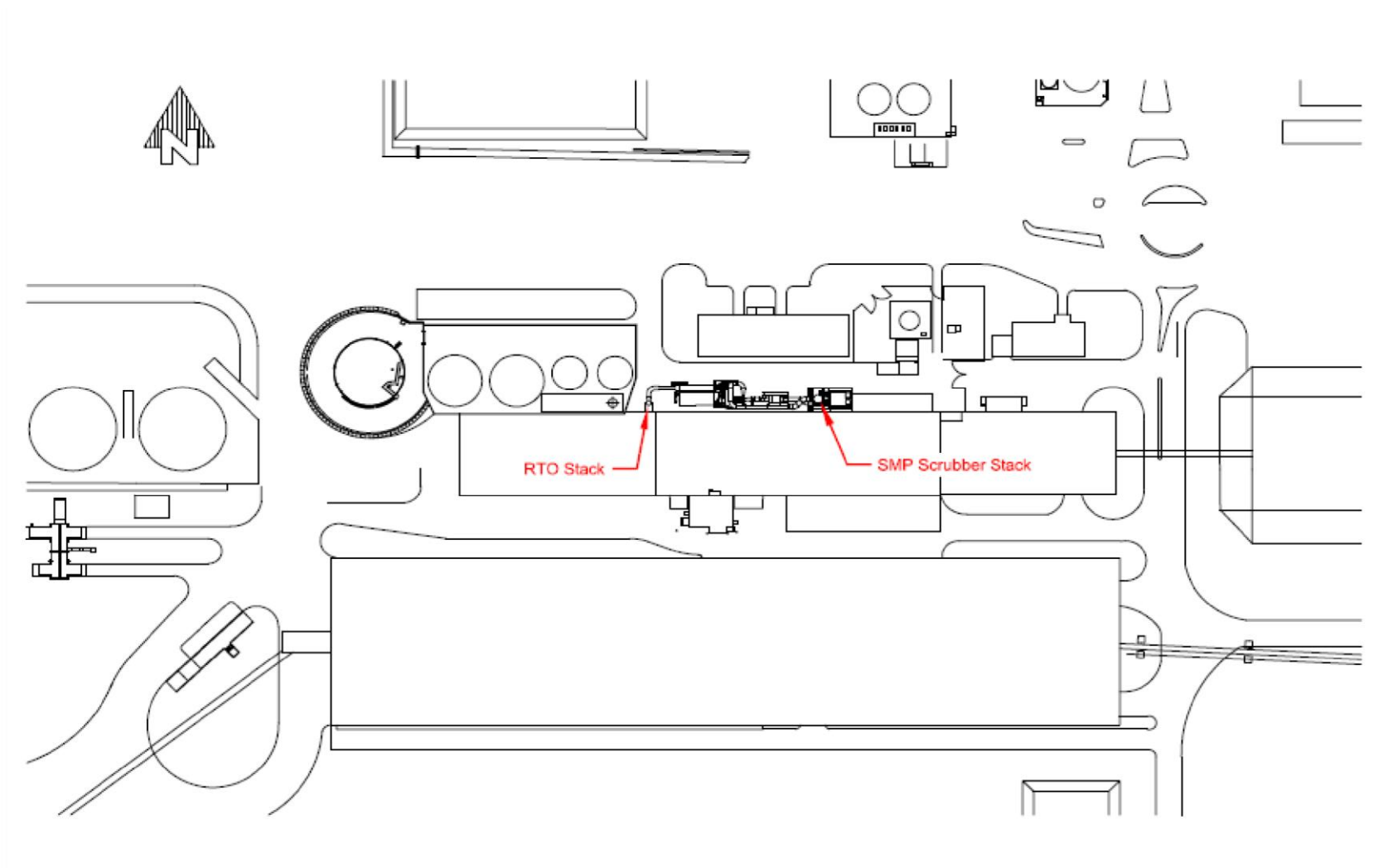

Figure 6: Map of the Superphosphate Manufacturing Plant discharge points

L6107/1967/17 (date of amendment: 23 April 2026)

IR-T06 Licence template (v10.0) (May 2024)

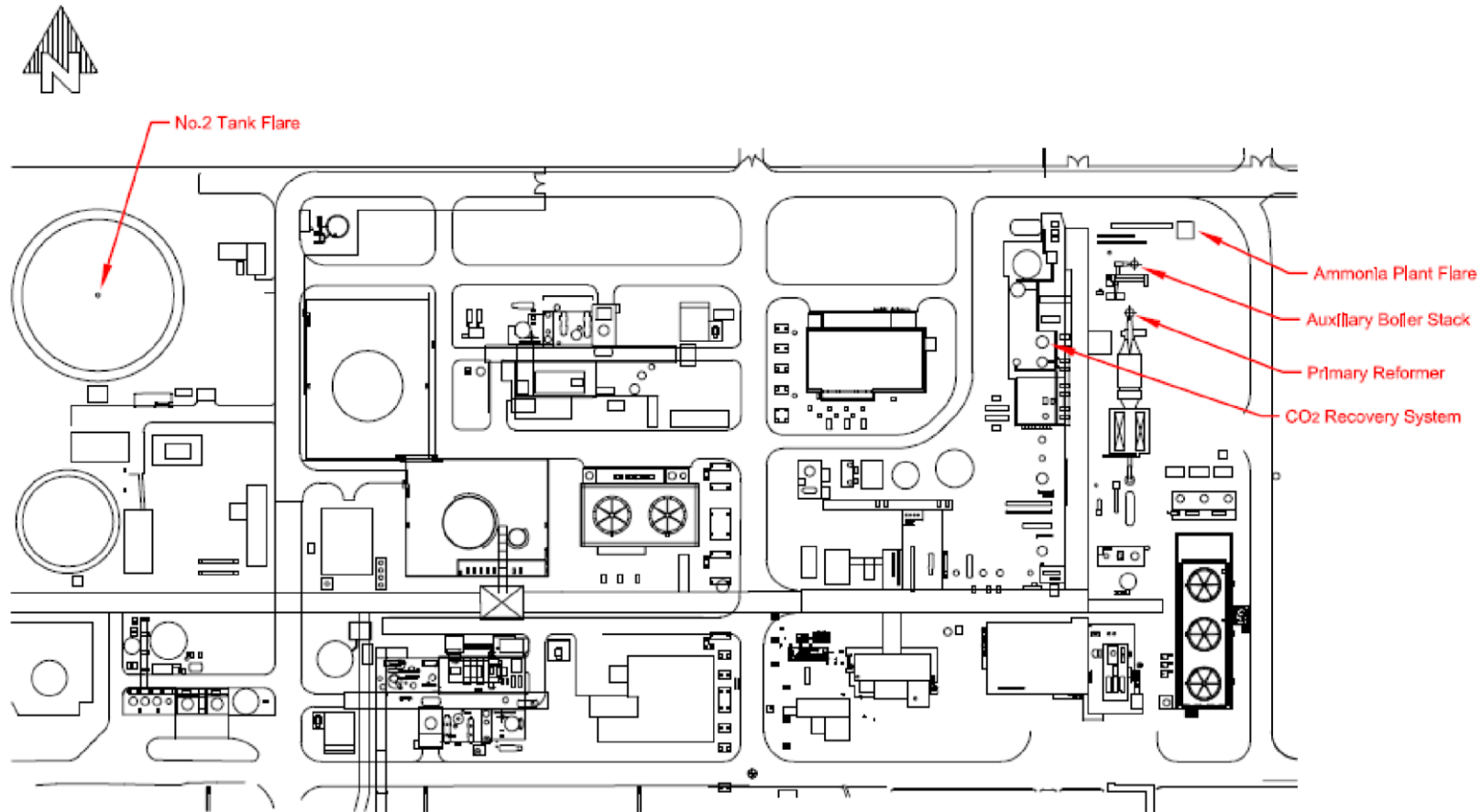

Figure 7: Map of the 2008 Ammonia plant discharge points

L6107/1967/17 (date of amendment: 23 April 2026)

IR-T06 Licence template (v10.0) (May 2024)

Schedule 2

Table 7: Gaseous emission points during normal operation

| Emission point | Emission point abbreviation | Stack height above ground level (m) | Density range (kg/m ³) | Efflux velocity (m/s) | Volume (m ³ /s) | Exit Temp (°C) |
|---|-----------------------------|-------------------------------------|------------------------------------|-----------------------|----------------------------|----------------|
| Superphosphate Scrubber Stack | SMP | 37.4 | 1.01 | N/A | 19.3 | 55 |
| Superphosphate Regenerative Thermal Oxidiser Stack | RTO | 27 | N/A | N/A | N/A | 136 |
| Granulation Plant Scrubber Stack | GP | 43.1 | 1.01 | N/A | 36.0 | 54 |
| Granulation Plant Deduster Stack | GPDS | N/A | N/A | N/A | N/A | N/A |
| 2008 Ammonium Nitrate Prilling Plant Scrubber Stack | PP2 | 65 | N/A | N/A | 62.7 | 35 |
| Nitric Acid Plants stacks: - during startup | NAP1, NAP2 & NAP3 | 64.5 | 0.957 | 27.5 | 17.2 | 60 |
| Nitric Acid Plants stacks: - 100% load ¹ | | | 0.897 | | 26.2 | 109 |
| Nitric Acid Plants stacks: - 70% load ² | | | 0.854 | | 19.3 | 128 |
| 2000 Ammonia plant Primary reformer stack | AP2 | 30 | 0.77 | N/A | 37 | 162 |
| CO ₂ recovery system | | 21 | 2.03 | | 4.79 | 50 |
| Flare tower (two) | | 40 | N/A | | N/A | N/A |
| Auxiliary boiler stack | | 30 | N/A | | N/A | N/A |
| No.2 Tank Flare (flares gas from Tanks 1 & 2 in an emergency situation) | | N/A | N/A | | N/A | N/A |

Note 1: Operating at 100% of full load

Note 2: Operating at 70% of full load

Schedule 3: ANE Plant maps

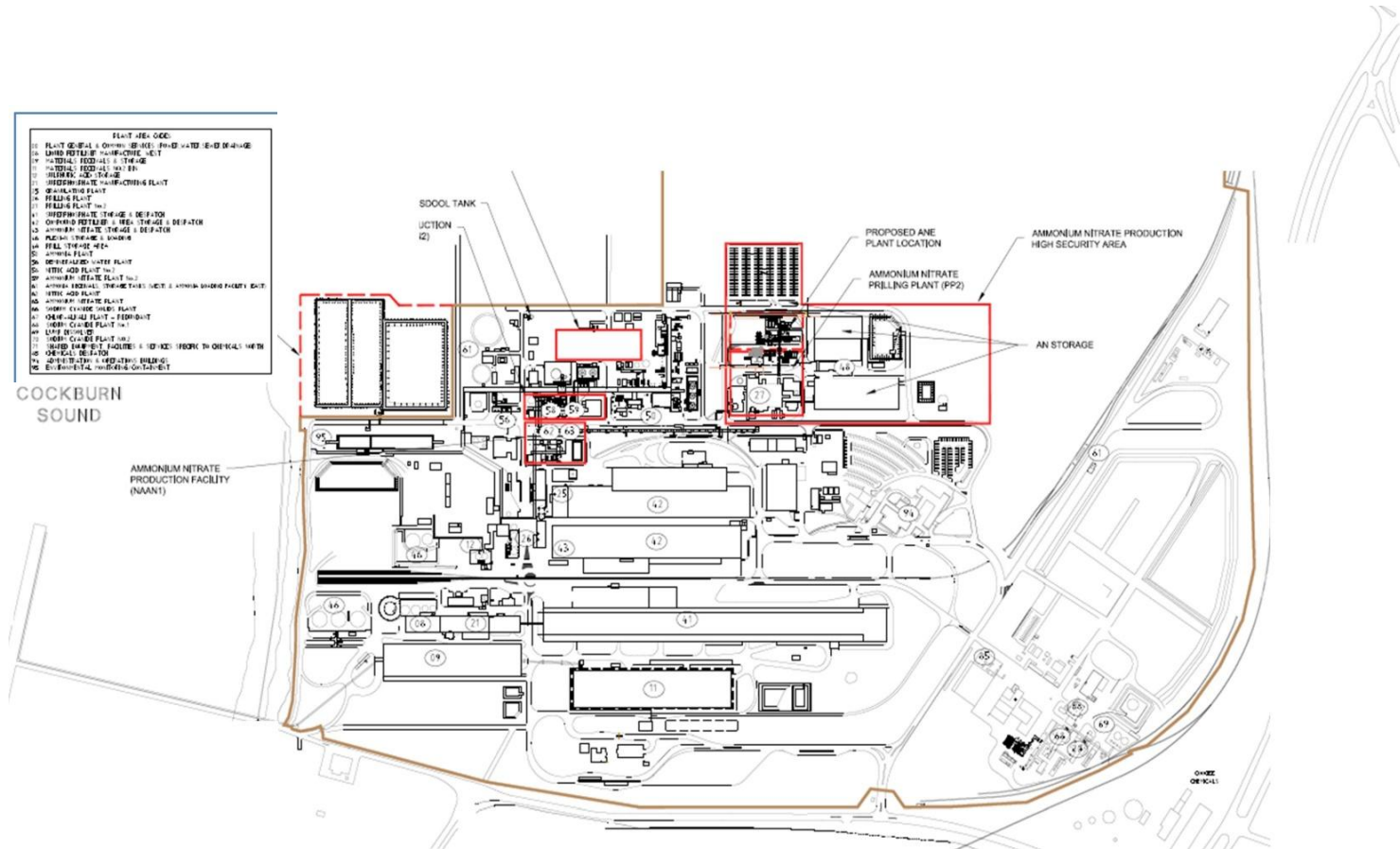

Figure 8: ANE Plant location

L6107/1967/17 (date of amendment: 23 April 2026)

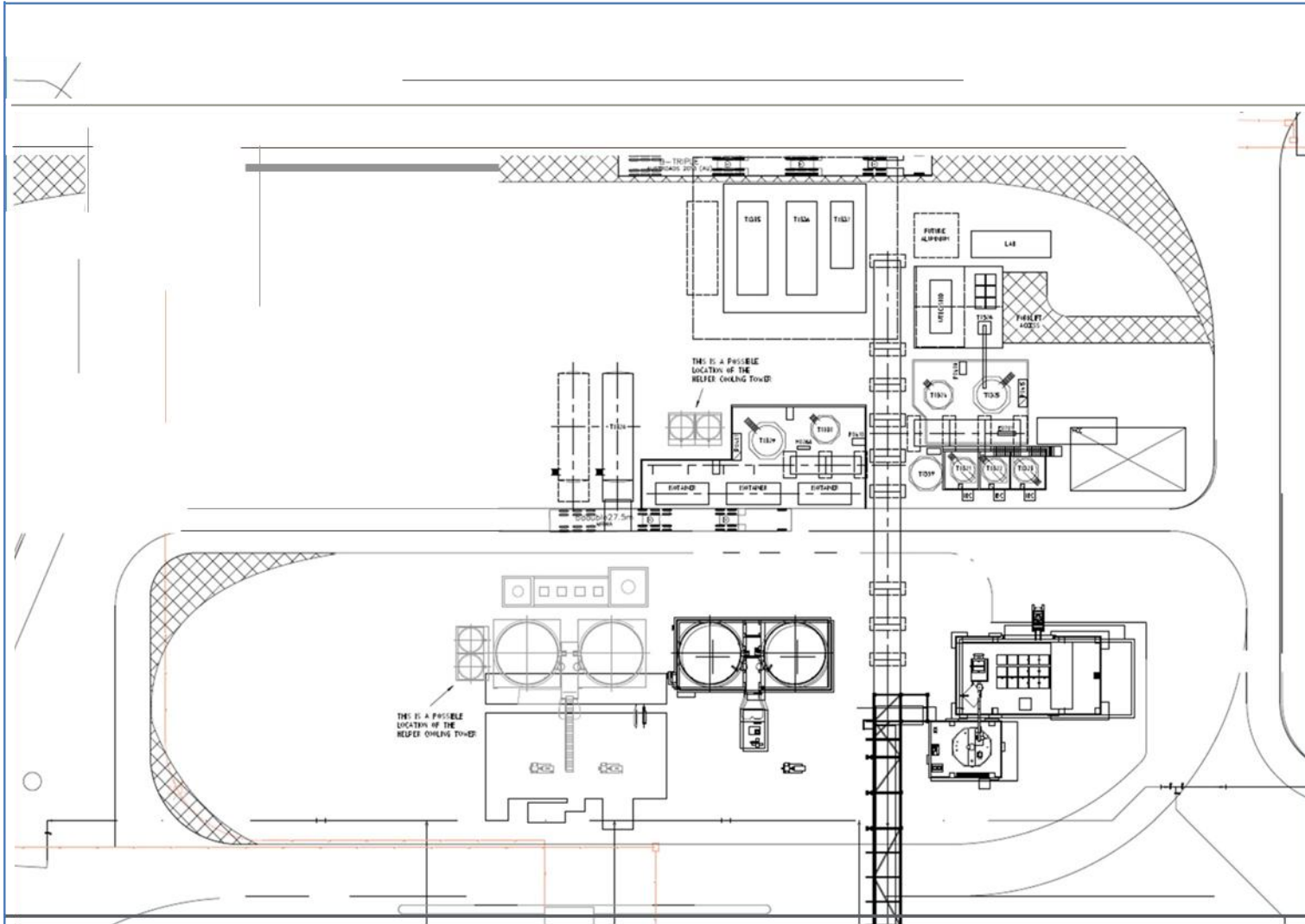

Figure 9: ANE Plant layout map

L6107/1967/17 (date of amendment: 23 April 2026)

Schedule 4: Water Treatment Plant maps

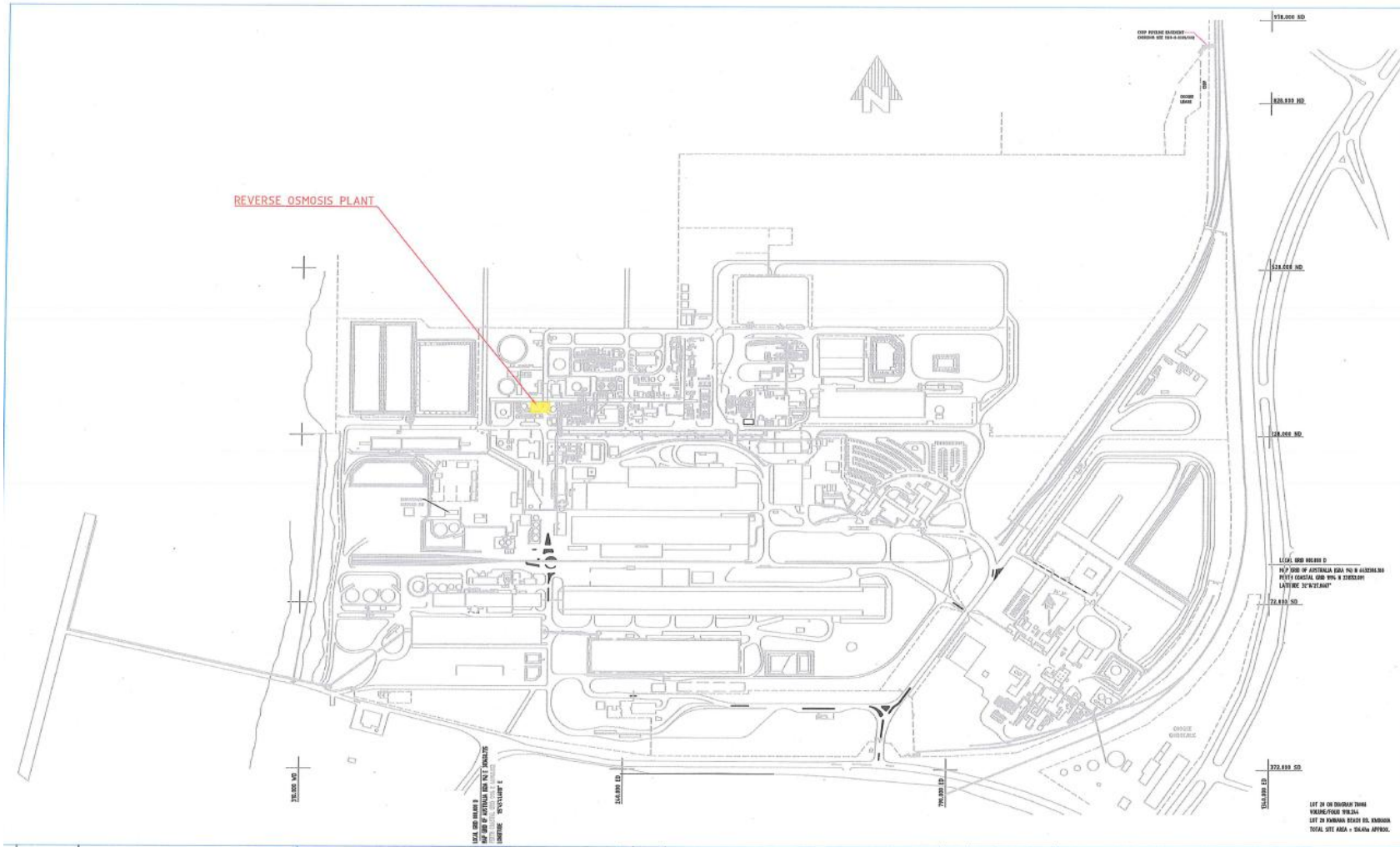

Figure 10: Water Treatment Plant location

L6107/1967/17 (date of amendment: 23 April 2026)

IR-T06 Licence template (v10.0) (May 2024)

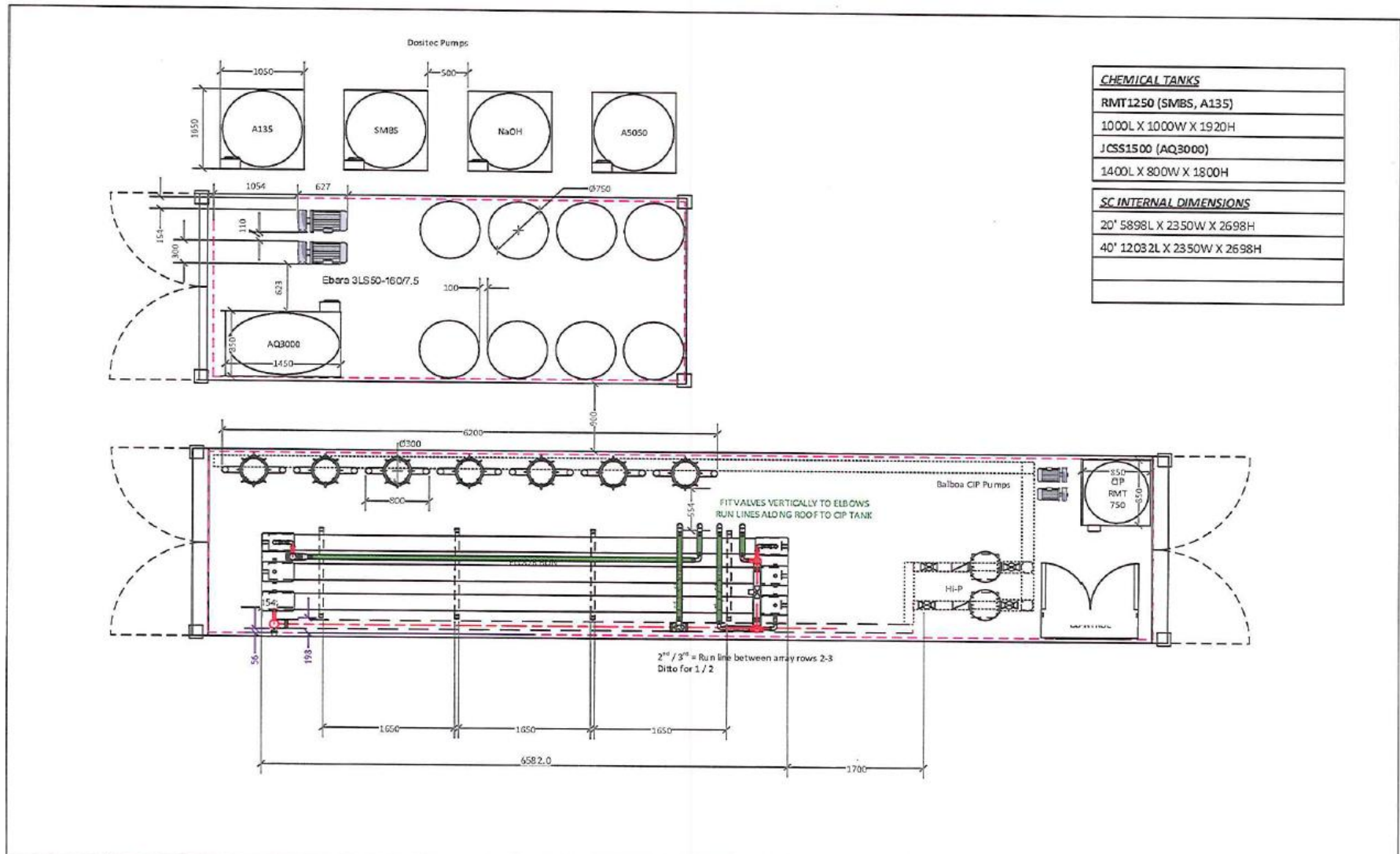

Figure 11: Water Treatment – general layout

L6107/1967/17 (date of amendment: 23 April 2026)